

REPORT NUMBER: ITL46481

DATE: 06/03/97

PREPARED FOR: B-K LIGHTING, INC.

CATALOG NUMBER: LA-51-XXX-13-C

LUMINAIRE: MACHINED METAL LAMP/SOCKET HOUSING WITH WHITE PAINTED GENERAL INTERIOR FINISH, CLEAR FLAT GLASS ENCLOSURE IN METAL FRAME WITH CLEAR LINEAR PRISMATIC GLASS OVERLAY. PRISMS ORIENTED VERTICALLY.

LAMP: ONE 50-WATT PAR 30 HALOGEN INCANDESCENT, PHILIPS 50PAR30/H/SP, HORIZONTAL POSITION.

REPORT IS BASED ON 530 LUMENS PER LAMP.

FLOODLIGHT CHARACTERISTICS

PAGE 1

IES TYPE	5H X 3V
MAXIMUM CANDLEPOWER	886. AT 0.0 H, -0.3 V
HORIZONTAL BEAM ANGLE (50%)	54.3 deg
VERTICAL BEAM ANGLE (50%)	18.5 deg
HORIZONTAL FIELD ANGLE (10%)	87.3 deg
VERTICAL FIELD ANGLE (10%)	42.2 deg
BEAM LUMENS (EFFICIENCY)	154. (29.0 %)
FIELD LUMENS (EFFICIENCY)	283. (53.4 %)
TOTAL LUMENS (EFFICIENCY)	350. (66.0 %)

AXIAL CANDLEPOWER	DEG	HORIZ.	DEG	VERT.
	76.0	5.	28.5	58.
	68.0	10.	25.5	70.
	60.0	13.	22.5	85.
	52.0	23.	19.5	107.
	44.0	83.	16.5	147.
	36.0	212.	13.5	223.
	28.0	416.	10.5	358.
	20.0	665.	7.5	542.
	12.0	812.	4.5	740.
	4.0	875.	1.5	862.
	0.0	884.	0.0	884.
	-4.0	875.	-1.5	879.
	-12.0	812.	-4.5	764.
	-20.0	665.	-7.5	573.
	-28.0	416.	-10.5	371.
	-36.0	212.	-13.5	236.
	-44.0	83.	-16.5	149.
	-52.0	23.	-19.5	96.
	-60.0	13.	-22.5	66.
	-68.0	10.	-25.5	49.
	-76.0	5.	-28.5	38.

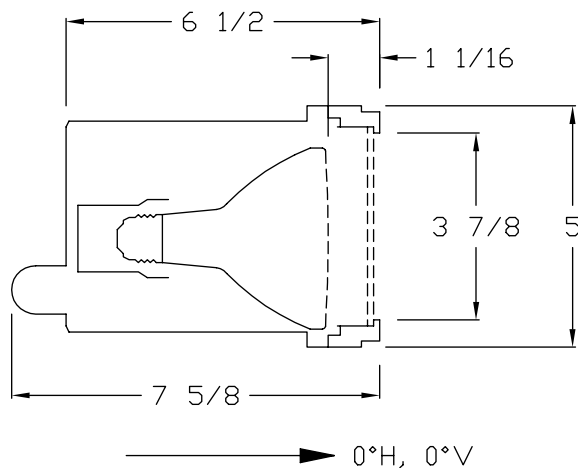

Checked MY

Approved R.P.BERGIN

ALL CANDELA AND LUMEN VALUES IN THIS REPORT ARE BASED ON RELATIVE PHOTOMETRY WHICH ASSUMES A BALLAST FACTOR= 1.000. ANY CALCULATIONS PREPARED FROM THESE DATA SHOULD INCLUDE AN APPROPRIATE BALLAST FACTOR.

THIS REPORT IS BASED ON PUBLISHED INDUSTRY PROCEDURES. FIELD PERFORMANCE MAY DIFFER FROM LABORATORY PERFORMANCE.

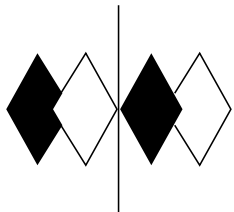

itl boulder
THE LIGHT CENTER OF THE INDUSTRY SINCE 1955

INDEPENDENT TESTING LABORATORIES, INC.
3386 LONGHORN ROAD, BOULDER, CO 80302 USA

PHONE: (303)442-1255 • FAX: (303)449-5274 • E-MAIL: itl@itlboulder.com • WEBSITE: www.itlboulder.com

REPORT NUMBER: ITL46481
PREPARED FOR: B-K LIGHTING, INC.

DATE: 06/03/97

CANDELA TABULATION

PAGE 2

AVERAGE OF RIGHT AND LEFT SIDES

	0.0	4.0	12.0	20.0	28.0	36.0	44.0	52.0	60.0	68.0	76.0
28.5	58.	56.	48.	42.	32.	23.	15.	9.	7.	5.	3.
25.5	70.	67.	57.	49.	38.	28.	18.	10.	7.	6.	3.
22.5	85.	81.	69.	62.	48.	35.	22.	11.	8.	7.	3.
19.5	107.	103.	92.	83.	65.	47.	28.	13.	9.	7.	4.
16.5	147.	144.	131.	122.	94.	65.	36.	15.	9.	8.	4.
13.5	223.	219.	201.	188.	144.	91.	46.	17.	10.	9.	4.
10.5	358.	346.	326.	288.	212.	124.	57.	19.	11.	9.	4.
7.5	542.	527.	491.	423.	293.	158.	68.	21.	12.	10.	4.
4.5	740.	728.	689.	566.	364.	189.	77.	22.	13.	10.	4.
1.5	862.	853.	794.	652.	408.	209.	82.	23.	13.	10.	5.
0.0	884.	875.	812.	665.	416.	212.	83.	23.	13.	10.	5.
-1.5	879.	870.	804.	657.	412.	210.	82.	23.	13.	10.	5.
-4.5	764.	756.	702.	579.	370.	190.	76.	22.	13.	10.	4.
-7.5	573.	569.	519.	434.	293.	156.	65.	20.	12.	10.	4.
-10.5	371.	369.	343.	295.	209.	119.	53.	18.	11.	9.	4.
-13.5	236.	238.	221.	191.	142.	87.	42.	16.	10.	9.	4.
-16.5	149.	148.	137.	121.	95.	62.	33.	14.	10.	8.	4.
-19.5	96.	95.	88.	78.	64.	45.	26.	13.	9.	7.	4.
-22.5	66.	66.	61.	54.	43.	33.	20.	11.	8.	6.	3.
-25.5	49.	49.	45.	39.	32.	24.	16.	9.	7.	6.	3.
-28.5	38.	38.	35.	31.	25.	19.	13.	8.	7.	5.	3.

BEAM EDGE = 443. CP = 50% OF MAX.
FIELD EDGE = 89. CP = 10% OF MAX.



itl boulder
THE LIGHT CENTER OF THE INDUSTRY SINCE 1955

INDEPENDENT TESTING LABORATORIES, INC.
3386 LONGHORN ROAD, BOULDER, CO 80302 USA

PHONE: (303)442-1255 • FAX: (303)449-5274 • E-MAIL: itl@itlboulder.com • WEBSITE: www.itlboulder.com

REPORT NUMBER: ITL46481
PREPARED FOR: B-K LIGHTING, INC.

DATE: 06/03/97

CANDELA TABULATION -- FIELD ONLY

PAGE 3

AVERAGE OF RIGHT AND LEFT SIDES

	0.0	4.0	12.0	20.0	28.0	36.0	44.0	52.0	60.0	68.0	76.0
28.5											
25.5											
22.5											
19.5	107.	103.	92.								
16.5	147.	144.	131.	122.	94.						
13.5	223.	219.	201.	188.	144.	91.					
10.5	358.	346.	326.	288.	212.	124.					
7.5	542.	527.	491.	423.	293.	158.					
4.5	740.	728.	689.	566.	364.	189.					
1.5	862.	853.	794.	652.	408.	209.					
0.0	884.	875.	812.	665.	416.	212.					
-1.5	879.	870.	804.	657.	412.	210.					
-4.5	764.	756.	702.	579.	370.	190.					
-7.5	573.	569.	519.	434.	293.	156.					
-10.5	371.	369.	343.	295.	209.	119.					
-13.5	236.	238.	221.	191.	142.						
-16.5	149.	148.	137.	121.	95.						
-19.5	96.	95.									
-22.5											
-25.5											
-28.5											

BEAM EDGE = 443. CP = 50% OF MAX.
FIELD EDGE = 89. CP = 10% OF MAX.



INDEPENDENT TESTING LABORATORIES, INC.
3386 LONGHORN ROAD, BOULDER, CO 80302 USA

PHONE: (303)442-1255 • FAX: (303)449-5274 • E-MAIL: itl@itlboulder.com • WEBSITE: www.itlboulder.com

REPORT NUMBER: ITL46481
PREPARED FOR: B-K LIGHTING, INC.

DATE: 06/03/97

LUMEN TABULATION

PAGE 4

AVERAGE OF RIGHT AND LEFT SIDES

	0	8	16	24	32	40	48	56	64	72	80	TOTAL
30												
	0.	0.	0.	0.	0.	0.	0.	0.	0.	0.	0.	2.
27												
	0.	0.	0.	0.	0.	0.	0.	0.	0.	0.	0.	2.
24												
	1.	0.	0.	0.	0.	0.	0.	0.	0.	0.	0.	2.
21												
	1.	1.	1.	0.	0.	0.	0.	0.	0.	0.	0.	3.
18												
	1.	1.	1.	1.	0.	0.	0.	0.	0.	0.	0.	4.
15												
	2.	1.	1.	1.	1.	0.	0.	0.	0.	0.	0.	6.
12												
	3.	2.	2.	1.	1.	0.	0.	0.	0.	0.	0.	9.
9												
	4.	4.	3.	2.	1.	0.	0.	0.	0.	0.	0.	14.
6												
	5.	5.	4.	2.	1.	0.	0.	0.	0.	0.	0.	18.
3												
	6.	6.	4.	3.	1.	0.	0.	0.	0.	0.	0.	21.
0												
	6.	6.	5.	3.	1.	0.	0.	0.	0.	0.	0.	21.
-3												
	6.	5.	4.	2.	1.	0.	0.	0.	0.	0.	0.	19.
-6												
	4.	4.	3.	2.	1.	0.	0.	0.	0.	0.	0.	14.
-9												
	3.	2.	2.	1.	1.	0.	0.	0.	0.	0.	0.	10.
-12												
	2.	2.	1.	1.	1.	0.	0.	0.	0.	0.	0.	6.
-15												
	1.	1.	1.	1.	0.	0.	0.	0.	0.	0.	0.	4.
-18												
	1.	1.	1.	0.	0.	0.	0.	0.	0.	0.	0.	3.
-21												
	0.	0.	0.	0.	0.	0.	0.	0.	0.	0.	0.	2.
-24												
	0.	0.	0.	0.	0.	0.	0.	0.	0.	0.	0.	1.
-27												
	0.	0.	0.	0.	0.	0.	0.	0.	0.	0.	0.	1.
-30												
	46.	42.	34.	22.	11.	5.	1.	1.	0.	0.	0.	162.

LUMEN TOTAL THIS PAGE = 162.



INDEPENDENT TESTING LABORATORIES, INC.
3386 LONGHORN ROAD, BOULDER, CO 80302 USA

PHONE: (303)442-1255 • FAX: (303)449-5274 • E-MAIL: itl@itlboulder.com • WEBSITE: www.itlboulder.com

REPORT NUMBER: ITL46481
PREPARED FOR: B-K LIGHTING, INC.

DATE: 06/03/97

LUMEN TABULATION -- FIELD ONLY

PAGE 5

AVERAGE OF RIGHT AND LEFT SIDES

	0	8	16	24	32	40	48	56	64	72	80	TOTAL
30												0.
27												0.
24												0.
21												0.
18	1.	1.										1.
15	1.	1.	1.	1.								3.
12	2.	1.	1.	1.	1.							6.
9	3.	2.	2.	1.	1.							9.
6	4.	4.	3.	2.	1.							13.
3	5.	5.	4.	2.	1.							18.
0	6.	6.	4.	3.	1.							20.
-3	6.	6.	5.	3.	1.							20.
-6	6.	5.	4.	2.	1.							18.
-9	4.	4.	3.	2.	1.							14.
-12	3.	2.	2.	1.	1.							9.
-15	2.	2.	1.	1.								6.
-18	1.	1.	1.	1.								4.
-21	1.											1.
-24												0.
-27												0.
-30												0.
	43.	39.	31.	20.	9.	0.	0.	0.	0.	0.	0.	142.

LUMEN TOTAL THIS PAGE = 142.

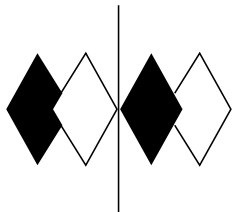

itl boulder
THE LIGHT CENTER OF THE INDUSTRY SINCE 1955

INDEPENDENT TESTING LABORATORIES, INC.
3386 LONGHORN ROAD, BOULDER, CO 80302 USA

PHONE: (303)442-1255 • FAX: (303)449-5274 • E-MAIL: itl@itlboulder.com • WEBSITE: www.itlboulder.com

REPORT NUMBER: ITL46481
PREPARED FOR: B-K LIGHTING, INC.

DATE: 06/03/97

ISOCANDELA CURVES

PAGE 6

AVERAGE OF RIGHT AND LEFT SIDES

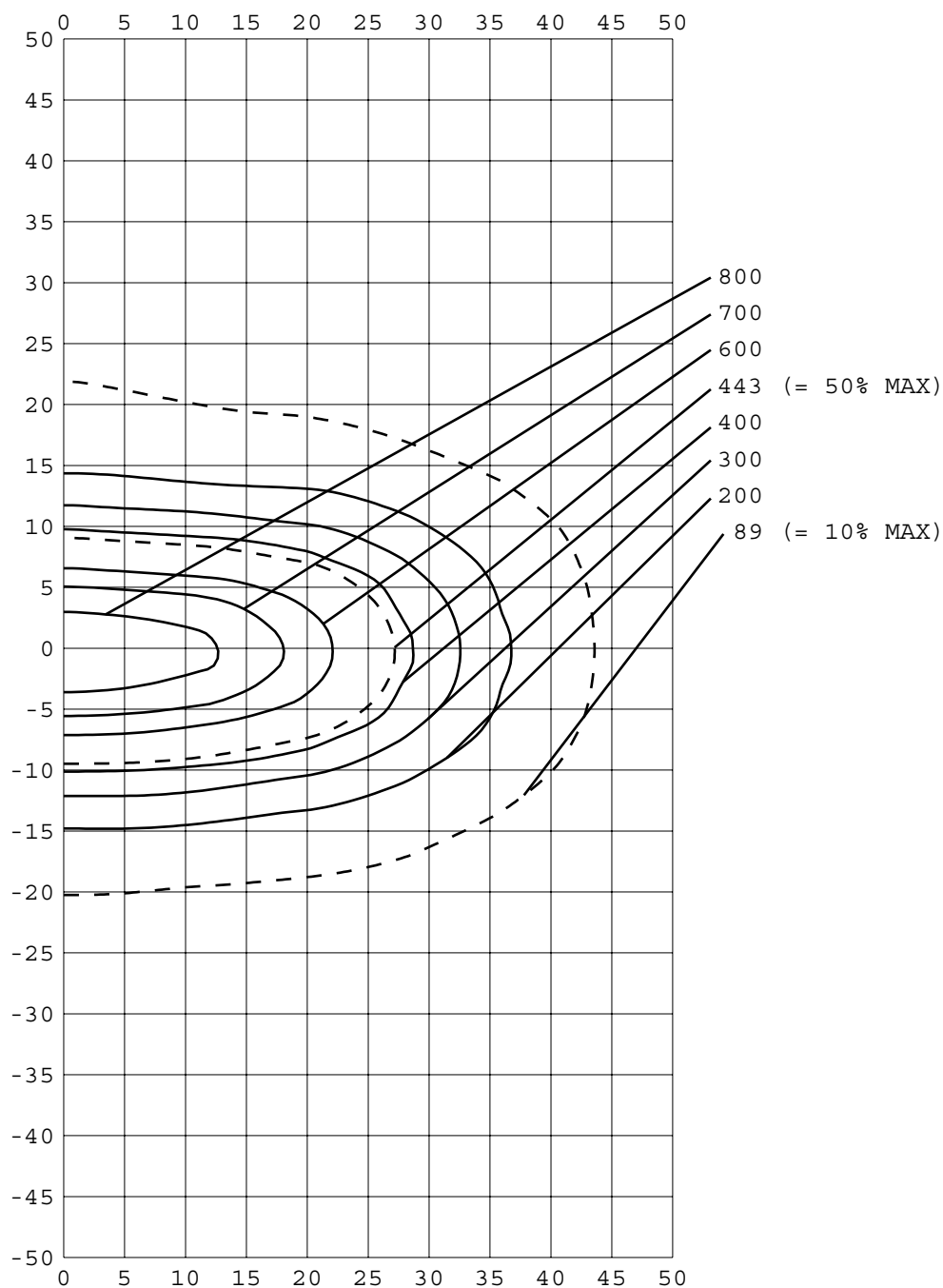

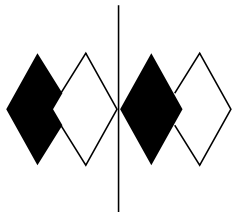

itl boulder
THE LIGHT CENTER OF THE INDUSTRY SINCE 1955

INDEPENDENT TESTING LABORATORIES, INC.
3386 LONGHORN ROAD, BOULDER, CO 80302 USA

PHONE: (303)442-1255 • FAX: (303)449-5274 • E-MAIL: itl@itlboulder.com • WEBSITE: www.itlboulder.com

REPORT NUMBER: ITL46481
PREPARED FOR: B-K LIGHTING, INC.

DATE: 06/03/97

CANDELA TABULATION -- 10 BY 10 INCREMENTS

PAGE 7

AVERAGE OF RIGHT AND LEFT SIDES

	0.0	5.0	15.0	25.0	35.0	45.0	55.0	65.0	75.0	85.0
85.0	0.	1.	0.	0.	0.	0.	0.	0.	0.	0.
75.0	2.	2.	2.	2.	1.	1.	1.	0.	0.	0.
65.0	6.	6.	5.	4.	3.	3.	2.	1.	0.	0.
55.0	9.	9.	8.	7.	6.	4.	4.	2.	1.	0.
45.0	13.	13.	13.	12.	10.	7.	5.	3.	1.	0.
35.0	36.	36.	31.	24.	18.	11.	7.	5.	2.	0.
25.0										0.
15.0										0.
5.0										0.
0.0	see page 2									0.
-5.0										0.
-15.0										0.
-25.0										0.
-35.0	21.	22.	21.	18.	13.	9.	6.	4.	2.	0.
-45.0	12.	12.	12.	10.	8.	6.	4.	3.	1.	0.
-55.0	7.	7.	7.	6.	5.	4.	3.	1.	1.	0.
-65.0	4.	4.	4.	4.	3.	2.	2.	1.	0.	0.
-75.0	2.	2.	2.	2.	1.	1.	0.	0.	0.	0.
-85.0	0.	1.	0.	0.	0.	0.	0.	0.	0.	0.

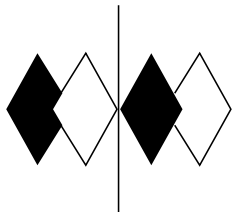

itl boulder
THE LIGHT CENTER OF THE INDUSTRY SINCE 1955

INDEPENDENT TESTING LABORATORIES, INC.
3386 LONGHORN ROAD, BOULDER, CO 80302 USA

PHONE: (303)442-1255 • FAX: (303)449-5274 • E-MAIL: itl@itlboulder.com • WEBSITE: www.itlboulder.com

REPORT NUMBER: ITL46481
PREPARED FOR: B-K LIGHTING, INC.

DATE: 06/03/97

LUMEN TABULATION -- 10 BY 10 INCREMENTS

PAGE 8

AVERAGE OF RIGHT AND LEFT SIDES

	0	10	20	30	40	50	60	70	80	90	TOTAL
90											
	0.	0.	0.	0.	0.	0.	0.	0.	0.	0.	0.
80											
	0.	0.	0.	0.	0.	0.	0.	0.	0.	0.	0.
70											
	0.	0.	0.	0.	0.	0.	0.	0.	0.	0.	1.
60											
	0.	0.	0.	0.	0.	0.	0.	0.	0.	0.	1.
50											
	0.	0.	0.	0.	0.	0.	0.	0.	0.	0.	2.
40											
	1.	1.	1.	0.	0.	0.	0.	0.	0.	0.	4.
30											
										0.	
20											
										0.	
10											
										0.	
0	see page 4										162.
										0.	
-10											
										0.	
-20											
										0.	
-30											
	1.	1.	0.	0.	0.	0.	0.	0.	0.	0.	2.
-40											
	0.	0.	0.	0.	0.	0.	0.	0.	0.	0.	1.
-50											
	0.	0.	0.	0.	0.	0.	0.	0.	0.	0.	1.
-60											
	0.	0.	0.	0.	0.	0.	0.	0.	0.	0.	1.
-70											
	0.	0.	0.	0.	0.	0.	0.	0.	0.	0.	0.
-80											
	0.	0.	0.	0.	0.	0.	0.	0.	0.	0.	0.
-90											
					175.					0.	175.

LUMEN TOTAL THIS PAGE = 175.