

DATE: \_\_\_\_\_ PROJECT: \_\_\_\_\_ TYPE: \_\_\_\_\_

CATALOG NUMBER LOGIC:

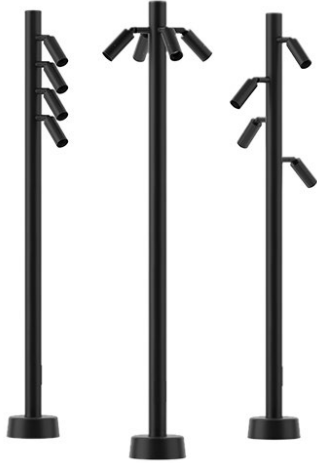

\*Only available with Horizontal Mounting.

\*\*120V only.

**CATALOG NUMBER LOGIC**

Example: RS4 - V1 - 12 - DE - TR - x122 - FL - 12 - 11 - A - INC - 120 - BLP

**MATERIAL**

(Blank) - Aluminum S - Steel

**SERIES**

RS4 - Round Straight 4"

**NUMBER OF FLOODLIGHTS & ORIENTATION**

**Vertical**

V1 - 1 Fixture V2 - 2 Fixtures V3 - 3 Fixtures V4 - 4 Fixtures

**Horizontal**

H2090 - 2 Fixtures @ 90° H2180 - 2 Fixtures @ 180° H3120 - 3 Fixtures @ 120°

H3090 - 3 Fixtures @ 90° H4090 - 4 Fixtures @ 90°

**Spiral (90° Clockwise Spacing)**

R2 - 2 Fixtures R3 - 3 Fixtures R4 - 4 Fixtures

**HEIGHT**

8 - 8' \*

10 - 10' \*

12 - 12'

16 - 16'

20 - 20'

**FIXTURE SERIES**

DE - TR - Denali Integral

**LED TYPE**

x98 - 13W LED/2700K/80CRI	x101 - 13W LED/2700K/90CRI	✓
x99 - 13W LED/3000K/80CRI	x102 - 13W LED/3000K/90CRI	✓
x103 - 13W LED/3500K/80CRI	x104 - 13W LED/3500K/90CRI	✓
x100 - 13W LED/4000K/80CRI	x121 - 13W LED/4000K/90CRI	✓
x122 - 21W LED/2700K/80CRI	x126 - 21W LED/2700K/90CRI	✓
x123 - 21W LED/3000K/80CRI	x127 - 21W LED/3000K/90CRI	✓
x124 - 21W LED/3500K/80CRI	x128 - 21W LED/3500K/90CRI	✓
x125 - 21W LED/4000K/80CRI	x129 - 21W LED/4000K/90CRI	✓

**OPTICS**

SP - Spot (17°) FL - Flood (45°) WFL - Wide Flood (55°)

**LENS TYPE**

9 - Clear (Included)

12 - Soft Focus 13 - Rectilinear

**SHIELDING**

11 - Honeycomb Baffle

**CAP STYLE**

A - 45°

B - 90°

C - Flush

D - 45° Less Weep Hole (Downward Aiming Only)

E - 90° Less Weep Hole (Downward Aiming Only)



**TITLE 24, JA8 COMPLIANT**

# DENALI ROUND POLE (INTEGRAL)

IP66 RATED

DATE:	PROJECT:	TYPE:
-------	----------	-------

CATALOG NUMBER LOGIC:

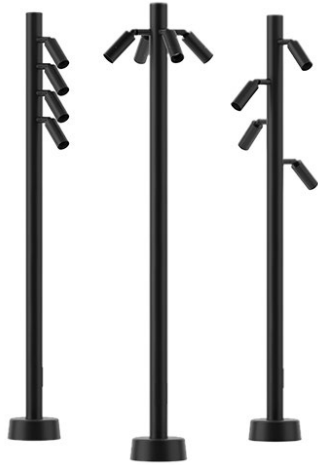

## CONTROL

ELV - Dimming Driver (For use with Electronic Low Voltage Dimmer)\*\*

INC - Dimming Driver (For use with Incandescent Dimmer)\*\*

010 - 0-10V Dimming Driver (Dimming ≤3-100%)

## INPUT VOLTAGE

120 - 120 VAC

277 - 277 VAC

## FINISH (See page 4 for full-color swatches) (Applies to pole and fixture)

Standard Finishes (BZP, BZW, BLP, BLW, WHP, WHW, SAP, VER)

Premium Finish (ABP, AMG, AQW, BCM, BGE, BPP, CAP, CMG, CRM, HUG, NBP, OCP, RMG, SDS, SMG, TXF, WCP, WIR)

Also available in RAL Finishes

*\*Only available with Horizontal Mounting.*

*\*\*120V only.*



**TITLE 24, JA8 COMPLIANT**

**B-K LIGHTING**

**MADE IN THE USA**

559.438.5800 | [INFO@BKLIGHTING.COM](mailto:INFO@BKLIGHTING.COM) | [BKLIGHTING.COM](http://BKLIGHTING.COM)

THIS DOCUMENT CONTAINS PROPRIETARY INFORMATION OF B-K LIGHTING, INC. AND ITS RECEIPT OR POSSESSION DOES NOT CONVEY ANY RIGHTS TO REPRODUCE, DISCLOSE ITS CONTENTS, OR TO MANUFACTURE, USE OR SELL ANYTHING IT MAY DESCRIBE. REPRODUCTION, DISCLOSURE OR USE WITHOUT SPECIFIC WRITTEN AUTHORIZATION OF B-K LIGHTING, INC. IS STRICTLY FORBIDDEN.

01/20/2023 SKU-1448 P2  
SUB-2874-00

DATE:

PROJECT:

TYPE:

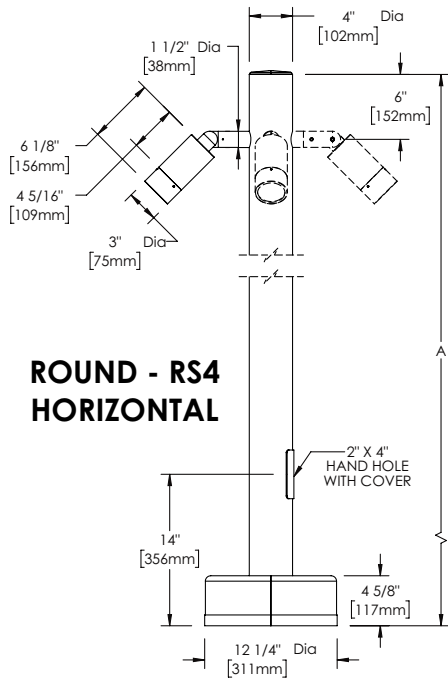

**ROUND - RS4  
HORIZONTAL**

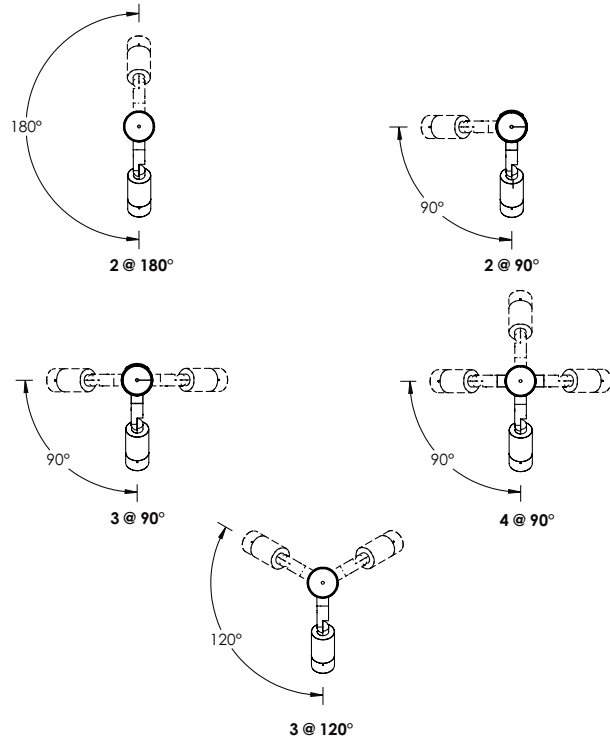

NOTES:

- "A" LENGTH DIMENSION OPTIONS: 8ft, 10ft, 12ft, 16ft, AND 20ft.
- ALL RS4 ALUMINUM 20ft POLES ARE OFFERED WITH A 100mph WINDSPEED RATING, WITH A 1.3 GUST FACTOR, UNDER 1994 AASHTO LTS-3; ALL OTHERS OFFERED WITH A 120mph RATING.

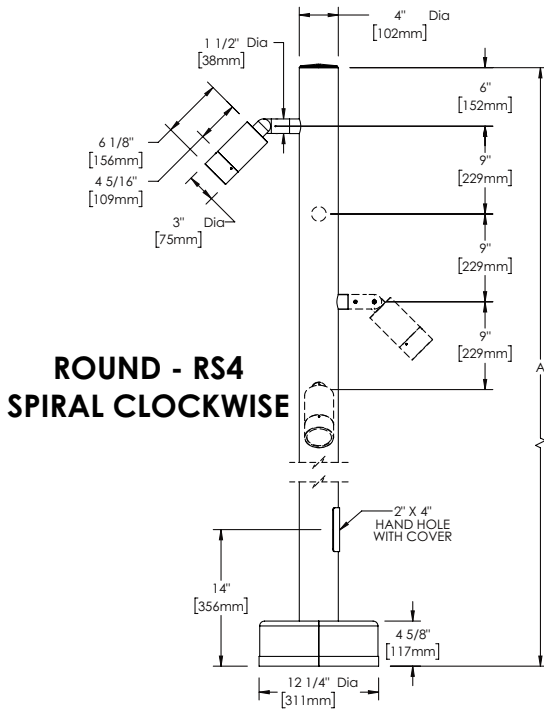

**ROUND - RS4  
SPIRAL CLOCKWISE**

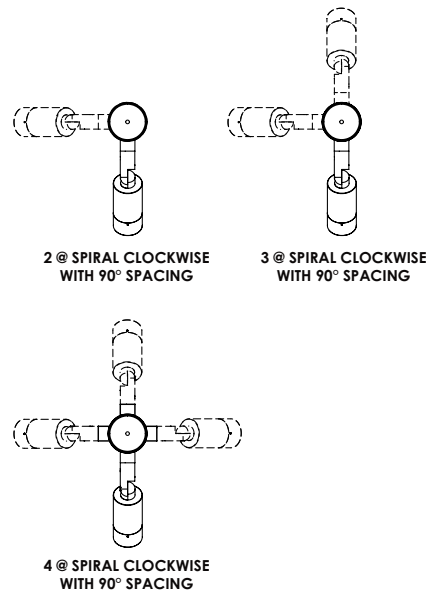

NOTES:

- "A" LENGTH DIMENSION OPTIONS: 12ft, 16ft, AND 20ft.
- ALL RS4 ALUMINUM 20ft POLES ARE OFFERED WITH A 100mph WINDSPEED RATING, WITH A 1.3 GUST FACTOR, UNDER 1994 AASHTO LTS-3; ALL OTHERS OFFERED WITH A 120mph RATING.

DATE:

PROJECT:

TYPE:

**ROUND - RS4  
VERTICAL**

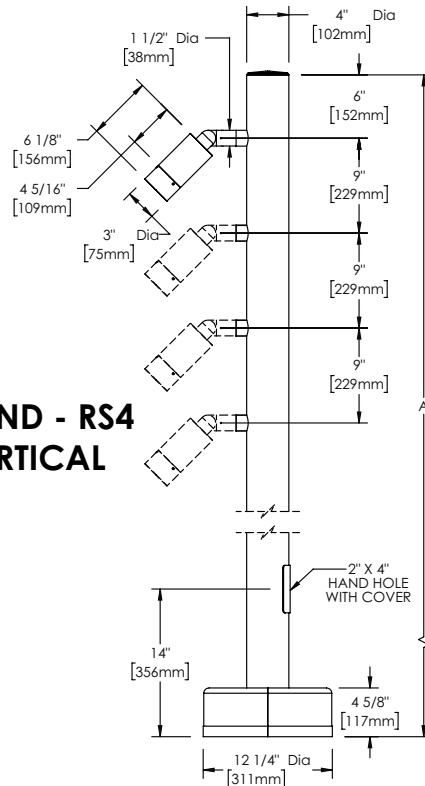

NOTES:

- "A" LENGTH DIMENSION OPTIONS: 12ft, 16ft, AND 20ft.
- ALL RS4 ALUMINUM 20ft POLES ARE OFFERED WITH A 100mph WINDSPEED RATING, WITH A 1.3 GUST FACTOR, UNDER 1994 AASHTO LTS-3; ALL OTHERS OFFERED WITH A 120mph RATING.

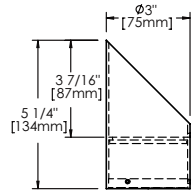

A/D CAP  
1:2 SCALE

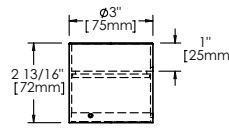

B/E CAP  
1:2 SCALE

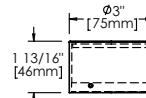

C CAP  
1:2 SCALE

**STANDARD FINISHES**



**PREMIUM FINISHES**

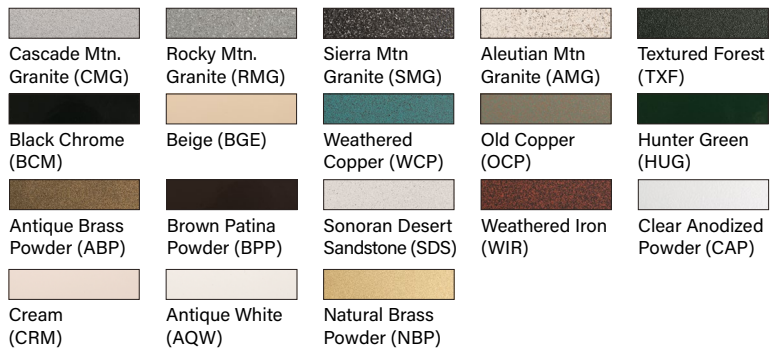

[Click Here](#) to view larger, full-color swatches of all available finishes on our website.

DATE:	PROJECT:	TYPE:
-------	----------	-------

ACCESSORIES (Configure separately)

SPECIFICATIONS

ELECTRICAL	WATTAGE	13W or 21W LED
	LED	COB technology and modular design with electrical quick disconnects allow for easy field upgrade and maintenance. LM-80 certified. Title 24, JA8 compliant options available. Minimum 50,000 hour rated life at 70% of initial lumens (L70).
	COLOR MANAGEMENT	COB technology delivers natural white light. Exact color point conformity exceeds ANSI C78.377 standard. Module exceeds 80 CRI (RA>80, R9.16). Color point uniformity 2 SDCM color control for 2700K-4000K CCT.
	WIRING	INC/ELV Wiring: 3 Wire, 18GA, Stranded, XLPE, 125°C, 300V, UL3265 rated wire 0-10 Wiring: 5 Wire, (3) 18GA and (2) 22GA, Stranded, XLPE, 125°C, 300V, UL3265 rated wire. Fixtures provided with 25ft leads.
	DRIVER	Incandescent/ELV Control Option Driver: Dimming driver for use with standard incandescent or electronic low voltage dimmers (10-100% range), 120VAC only. 0-10 Control Option Driver: Dimming driver for use with standard 0-10V dimmers (≤3-100% dim. range), 120-277VAC. With [1] 440mA (13W) / 700mA (21W). 50/60Hz. >0.9 Power Factor, (INC/ELV)10.0A/(0-10) <250mA in-rush current, .20%THD (nominal at 120VAC full load). Output over-voltage, overcurrent, and short circuit protection with auto recovery. Class 2 power supply; FCC47CFR Part 15 Compliant Class B (120VAC)/Class A (277VAC).
PHYSICAL	MATERIALS	Fixture furnished in copper-free aluminum (6061-T6).  Aluminum pole shafts are extruded from all new 6063 alloy aluminum tubing and heat treated to produce a T6 temper. Steel pole shafts are a one-piece construction - fabricated from a weldable grade carbon steel structural tubing with uniform wall thickness.
	BODY	Fixture has a unibody design with an enclosed, water-proof wireway and integral heat sink that is fully machined from solid billet. Anti-condensation and corrosion vent equalizes fixture pressure and eliminates potential for damage to internal components.
	KNUCKLE	Fixture includes 360HD Mounting System that features a mechanical taper lock, allowing full 180° vertical adjustment without the use of aim-limiting serrated teeth. High temperature, silicone 'O' Ring provides water-tight seal and compressive resistance to maintain fixture position. Design withstands 73 lbs. static load prior to movement for optical alignment with a ½" pipe thread for mounting. Biaxial source control additionally provides 360° horizontal rotation in addition to vertical adjustment. Aim & Lock technology allows precision adjustment without the redundant tightening and loosening of knuckle screw.
	CAP	Fixture cap fully machined and accommodates two (2) lens or louver media.
	LENS	Fixture cap provided with shock-resistant, tempered glass lens that is factory adhered to fixture cap and provides hermetically sealed optical compartment.
	OPTICS	Fixture provided with interchangeable optics that permit changes in the field.
	HARDWARE	Fixture provided with tamper-resistant, stainless steel hardware. 360HD hardware is black oxide treated for additional corrosion resistance.  Pole provided with tamper-resistant, stainless steel hardware.
	HANDHOLE	Grounding location 14" from the base of the pole. Round poles are provided with a 2" x 4" hand hole cover. Square poles are provided with a 3" x 5" hand hole cover. Hardware is included.
	ANCHOR KIT	Anchor bolts conform to AASTM F1554 Grade 55 and are provided with two hex nuts and two flat washers. Bolts have an 'L' bend on one end and are galvanized a minimum of 12" on the threaded end.
	BASE COVER	All standard poles come with a 2-piece cast aluminum base cover (Dart AC1/Dart 2T02AC from Valmont).
FINISH	StarGuard, our 15-stage chromate-free process applied to fixtures, cleans and conversion coats aluminum components prior to application of Class 'A' TGIC polyester powder coating and is RoHS compliant.	



**B-K LIGHTING**      **MADE IN THE USA**      559.438.5800 | INFO@BKLIGHTING.COM | BKLIGHTING.COM

DATE:	PROJECT:	TYPE:
-------	----------	-------

SPECIFICATIONS

PHYSICAL	FINISH	Pole comes complete with a 6-stage finishing process. All products receive the following: Cleaning, Phosphate Rinse (Steel Poles Only), Powder Coat Application, Curing, Palgard Epoxy Coating, and Blue Wrap. Blue Wrap is a multi-layered, UV and tear-resistant, vinyl bubble wrap designed to ensure the products reach the job site in top condition.
	WARRANTY	5-year limited warranty on fixture. 5-year finish warranty on pole provides a level of corrosion protection with the addition of an internal rust inhibitor.
	CERTIFICATION & LISTING	UL tested to IESNA LM-79. UL Listed. Certified to CAN/CSA/ANSI Standards. RoHS compliant components. Suitable for indoor or outdoor use, in wet locations, and for installation within 4' of the ground. IP66 Rated. Made in the USA with sustainable processes



# LAMP & DRIVER DATA (page 1 of 2)

DATE: PROJECT: TYPE:

## DRIVER ELECTRICAL DATA

Type	AC Input Range	Frequency Hz	Power Factor At Full Load (Efficiency)	THD	InRush Current	Operating Current	Operation Ambient Temperature	Dimmer Type	Dimmer Range
Integral	120VAC	50/60	> 0.9	20%	10A	440mA (13W)/700mA (21W)	-30° C ~ 70°C	TRIAC/ELV	1-100%
Integral	105-300VAC	50/60	> 0.9	20%	<250mA	440mA (13W)/700mA (21W)	-30° C ~ 90°C	0-10	≤3-100%

### LM79 DATA

BK No.	CCT (Typ.)	CRI (Typ.)	Input Watts (Typ.)
x98	2700	80	13
<b>x98</b>	<b>2700</b>	<b>80</b>	<b>13</b>
x98	2700	80	13
x99	3000	80	13
<b>x99</b>	<b>3000</b>	<b>80</b>	<b>13</b>
x99	3000	80	13
x103	3500	80	13
<b>x103</b>	<b>3500</b>	<b>80</b>	<b>13</b>
x103	3500	80	13
x100	4000	80	13
<b>x100</b>	<b>4000</b>	<b>80</b>	<b>13</b>
x100	4000	80	13
x101	2700	90	13
<b>x101</b>	<b>2700</b>	<b>90</b>	<b>13</b>
x101	2700	90	13
x102	3000	90	13
<b>x102</b>	<b>3000</b>	<b>90</b>	<b>13</b>
x102	3000	90	13
x104	3500	90	13
<b>x104</b>	<b>3500</b>	<b>90</b>	<b>13</b>
x104	3500	90	13
x121	4000	90	13
<b>x121</b>	<b>4000</b>	<b>90</b>	<b>13</b>
x121	4000	90	13
x122	2700	80	21
<b>x122</b>	<b>2700</b>	<b>80</b>	<b>21</b>
x122	2700	80	21
x123	3000	80	21
<b>x123</b>	<b>3000</b>	<b>80</b>	<b>21</b>
x123	3000	80	21
x124	3500	80	21
<b>x124</b>	<b>3500</b>	<b>80</b>	<b>21</b>
x124	3500	80	21
x125	4000	80	21
<b>x125</b>	<b>4000</b>	<b>80</b>	<b>21</b>
x125	4000	80	21

L70 Data
50,000
<b>50,000</b>
50,000
50,000
<b>50,000</b>
50,000
50,000
<b>50,000</b>
50,000
50,000
<b>50,000</b>
50,000
50,000
<b>50,000</b>
50,000
50,000
<b>50,000</b>
50,000
50,000
<b>50,000</b>
50,000
50,000
<b>50,000</b>
50,000
50,000
<b>50,000</b>
50,000
50,000
<b>50,000</b>
50,000
50,000
<b>50,000</b>
50,000
50,000
<b>50,000</b>
50,000

### OPTICAL DATA

Angle	CBCP	Del. Lumens	Muliplier
17	6,480	829	0.92
<b>45</b>	<b>1,773</b>	<b>1,041</b>	<b>0.92</b>
55	1,478	1,180	0.92
17	6,796	869	0.96
<b>45</b>	<b>1,860</b>	<b>1,091</b>	<b>0.96</b>
55	1,550	1,237	0.96
17	6,685	855	0.95
<b>45</b>	<b>1,829</b>	<b>1,074</b>	<b>0.95</b>
55	1,525	1,217	0.95
17	7,059	903	1.00
<b>45</b>	<b>1,931</b>	<b>1,134</b>	<b>1.00</b>
55	1,610	1,285	1.00
17	4,486	574	0.69
<b>45</b>	<b>1,228</b>	<b>720</b>	<b>0.69</b>
55	1,023	817	0.69
17	4,936	631	0.73
<b>45</b>	<b>1,350</b>	<b>793</b>	<b>0.73</b>
55	1,126	899	0.73
17	4,775	611	0.71
<b>45</b>	<b>1,307</b>	<b>767</b>	<b>0.71</b>
55	1,089	869	0.71
17	5,324	681	0.75
<b>45</b>	<b>1,457</b>	<b>855</b>	<b>0.75</b>
55	1,214	969	0.75
17	9,040	1,208	0.87
<b>45</b>	<b>2,437</b>	<b>1,359</b>	<b>0.87</b>
55	1,876	1,416	0.87
17	10,030	1,341	0.96
<b>45</b>	<b>2,704</b>	<b>1,508</b>	<b>0.96</b>
55	2,082	1,571	0.96
17	8,496	1,136	0.81
<b>45</b>	<b>2,290</b>	<b>1,277</b>	<b>0.81</b>
55	1,763	1,331	0.81
17	10,431	1,394	1.00
<b>45</b>	<b>2,812</b>	<b>1,568</b>	<b>1.00</b>
55	2,165	1,634	1.00

**B-K LIGHTING**

MADE IN THE USA

559.438.5800 | INFO@BKLIGHTING.COM | BKLIGHTING.COM

THIS DOCUMENT CONTAINS PROPRIETARY INFORMATION OF B-K LIGHTING, INC. AND ITS RECEIPT OR POSSESSION DOES NOT CONVEY ANY RIGHTS TO REPRODUCE, DISCLOSE ITS CONTENTS, OR TO MANUFACTURE, USE OR SELL ANYTHING IT MAY DESCRIBE. REPRODUCTION, DISCLOSURE OR USE WITHOUT SPECIFIC WRITTEN AUTHORIZATION OF B-K LIGHTING, INC. IS STRICTLY FORBIDDEN.

# LAMP & DRIVER DATA (page 2 of 2)

DATE: \_\_\_\_\_ PROJECT: \_\_\_\_\_ TYPE: \_\_\_\_\_

## LM79 DATA

BK No.	CCT (Typ.)	CRI (Typ.)	Input Watts (Typ.)
x126	2700	90	21
<b>x126</b>	<b>2700</b>	<b>90</b>	<b>21</b>
x126	2700	90	21
x127	3000	90	21
<b>x127</b>	<b>3000</b>	<b>90</b>	<b>21</b>
x127	3000	90	21
x128	3500	90	21
<b>x128</b>	<b>3500</b>	<b>90</b>	<b>21</b>
x128	3500	90	21
x129	4000	90	21
<b>x129</b>	<b>4000</b>	<b>90</b>	<b>21</b>
x129	4000	90	21

L70 Data
50,000
<b>50,000</b>
50,000
50,000
<b>50,000</b>
50,000
50,000
<b>50,000</b>
50,000
50,000
<b>50,000</b>
50,000

## OPTICAL DATA

Angle	CBCP	Del. Lumens	Muliplier
17	6120	818	0.68
<b>45</b>	<b>1650</b>	<b>920</b>	<b>0.68</b>
55	1270	959	0.68
17	7535	1007	0.75
<b>45</b>	<b>2031</b>	<b>1133</b>	<b>0.75</b>
55	1564	1180	0.75
17	5406	723	0.64
<b>45</b>	<b>1457</b>	<b>813</b>	<b>0.64</b>
55	1225	847	0.64
17	8148	1089	0.78
<b>45</b>	<b>2196</b>	<b>1225</b>	<b>0.78</b>
55	1691	1277	0.78

## OPTICS

Optic	Angle
Spot w/ 13 Accy	16 x 50
Spot	17°
Flood	45°
Wide Flood	55°