

Saratoga Series™

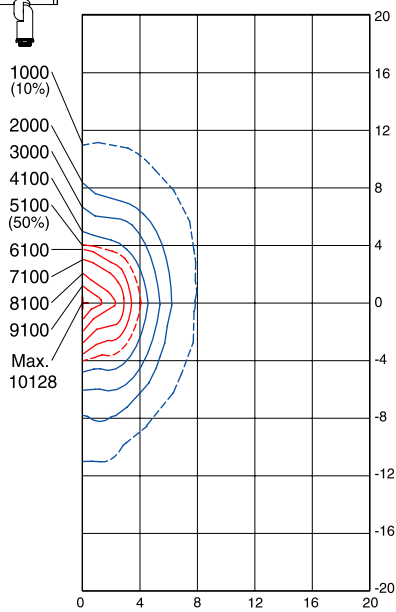

Spot



B-K filename: T4SPOT2.IES
Lamp: 50W T4 Halogen
IES Beam Type: 1H x 2V
Max. Candela: 10128 at 0°H; 0°V
Beam Spread (at 50% Max CD): 8°H, 8°V
Field Spread (at 10% Max CD): 16°H, 22°V
Total Lumens: 390

Flood

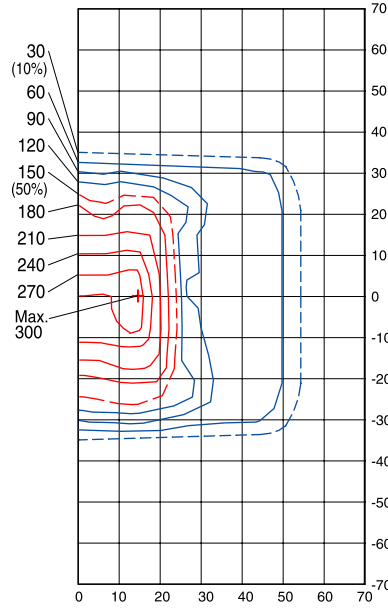

B-K filename: T4FREF3.IES
Lamp: 50W T4 Halogen
IES Beam Type: 6H x 4V
Max. Candela: 300 at 15°H; 0°V
Beam Spread (at 50% Max CD): 47°H, 48°V
Field Spread (at 10% Max CD): 108°H, 69°V
Total Lumens: 255

Wall Wash

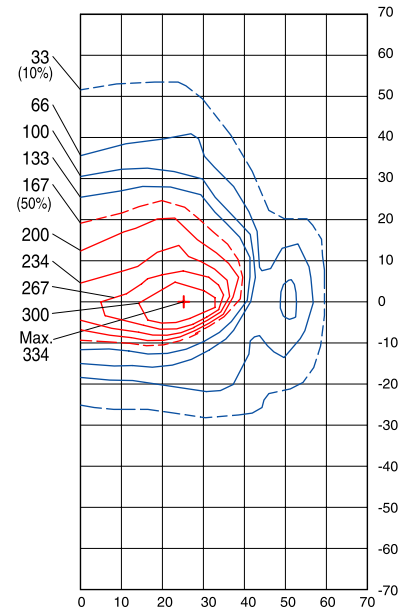

B-K filename: T4PREFA.IES
Lamp: 50W T4 Halogen
IES Beam Type: 6H x 5V
Max. Candela: 343 at 25°H; 0°V
Beam Spread (at 50% Max CD): 76°H, 27°V
Field Spread (at 10% Max CD): 118°H, 78°V
Total Lumens: 280

Rushmore Series™

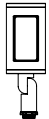

Spot

B-K filename: T4SPOT2.IES
Lamp: 50W T4 Halogen
IES Beam Type: 2H x 1V
Max. Candela: 10128 at 0°H; 0°V
Beam Spread (at 50% Max CD): 8°H, 8°V
Field Spread (at 10% Max CD): 22°H, 16°V
Total Lumens: 390

Flood

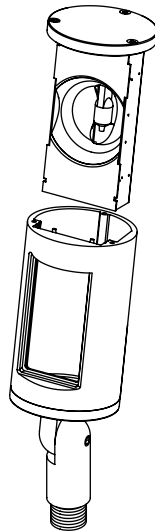

B-K filename: T4FREF3.IES
Lamp: 50W T4 Halogen
IES Beam Type: 4H x 6V
Max. Candela: 300 at 0°H; 15°V
Beam Spread (at 50% Max CD): 48°H, 47°V
Field Spread (at 10% Max CD): 69°H, 108°V
Total Lumens: 255

