

Yosemite Series™

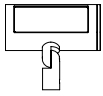

S3ot

Flood

Wall Wash

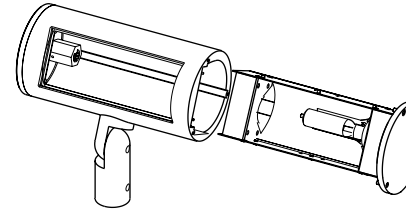
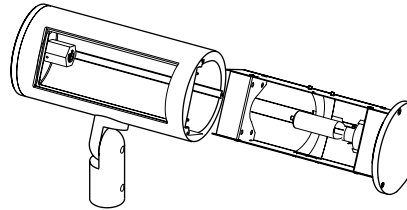
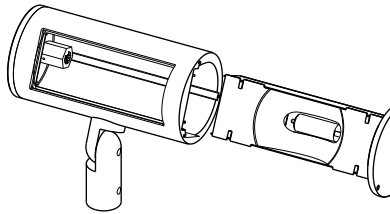

B-K filename: T6SPOT2B.IES
Lamp: 39W T6 Metal Halide
IES Beam Type: 3H x 2V
Max. Candela: 16442 at 0°H; 0°V
Beam Spread (at 50% Max CD): 12°H, 11°V
Field Spread (at 10% Max CD): 30°H, 22°V
Total Lumens: 1289

B-K filename: T650X505.IES
Lamp: 39W T6 Metal Halide
IES Beam Type: 6H x 4V
Max. Candela: 1378 at 2.5°H; 0°V
Beam Spread (at 50% Max CD): 52°H, 46°V
Field Spread (at 10% Max CD): 112°H, 64°V
Total Lumens: 1064

B-K filename: T6PATH.IES.IES
Lamp: 39W T6 Metal Halide
IES Beam Type: 7H x 5V
Max. Candela: 1458 at 15°H; -2.5°V
Beam Spread (at 50% Max CD): 103°H, 32°V
Field Spread (at 10% Max CD): 136°H, 77°V
Total Lumens: 1345

For 70W T6 Metal Halide lamp multiply candela and lumen values by 1.94.

Sequoia Series™

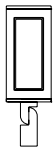

Spot

Flood

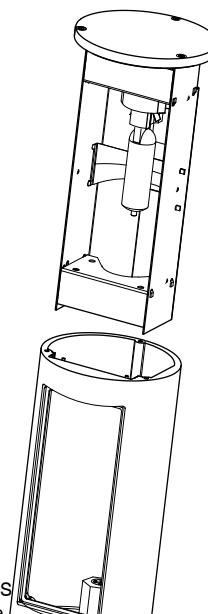
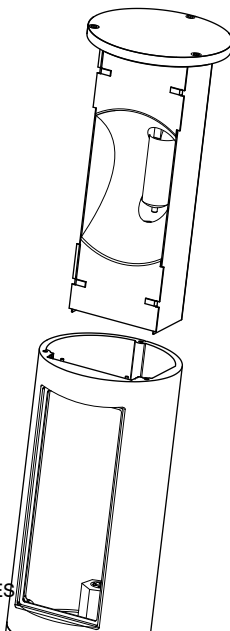

B-K filename: T6SPOT2B.IES
Lamp: 39W T6 Metal Halide
IES Beam Type: 2H x 3V
Max. Candela: 16442 at 0°H; 0°V
Beam Spread (at 50% Max CD): 11°H, 12°V
Field Spread (at 10% Max CD): 22°H, 30°V
Total Lumens: 1289

B-K filename: T650X505.IES
Lamp: 39W T6 Metal Halide
IES Beam Type: 4H x 6V
Max. Candela: 1378 at 0°H; 2.5°V
Beam Spread (at 50% Max CD): 46°H, 52°V
Field Spread (at 10% Max CD): 64°H, 112°V
Total Lumens: 1064

For 70W T6 Metal Halide lamp multiply candela and lumen values by 1.94.

