

ALPINE - Ceiling Mount - Remote Driver - LED Color Tuning - Asymmetrical Optics

TEMPORARILY UNAVAILABLE



IP66



Downloads

- Product Images (.zip)
- Technical Drawing (.zip)
- 2D (.dwg)
- 2D (.dxf)
- IES Files (.zip)
- BIM - Revit (.zip)
- Installation Instructions (.pdf)

Product Variant Examples

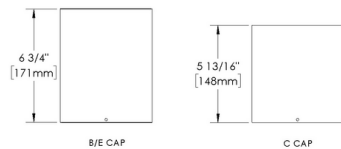
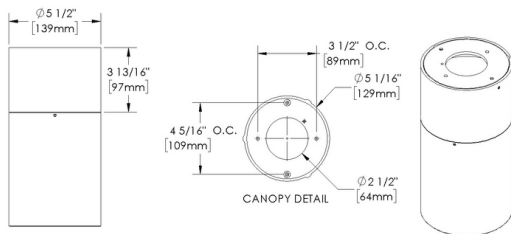

ALPINE - Ceiling Mount - Remote Driver - LED Color Tuning - Asymmetrical Optics

Available Logic & Configurations

AP- 01 **CM-** 02 **RMD-** 03 **LCT-** 04 **AL-** 05 **SM-** 06B **___-** 06C **OASY-** 06D

01 SERIES

AP - ALPINE

02 CATEGORY

CM - Ceiling Mount

03 DRIVER

RMD - Remote Driver

04 LIGHT SOURCE (TYPE)

LCT - LED Color Tuning

05 MATERIAL

AL - Aluminum

06B MOUNT

SM - Surface Mount

06C STYLE

CC - Cap C - Flush Lens

CE - Cap E - 90°

06D VERSION

OASY - Asymmetrical Optics

C26- 07 **BW-** 08 **12-** 10A **WL00-** 11 **___-** 12

07 LIGHT SOURCE

C26 - 1650-8000K + Saturation and Hue CRI95+ - 42W

08 OPTIC

BW - Batwing

10A LENS

12 - Soft Focus

11 WIRING LENGTH

WL00 - Standard

12 FINISH

Standard Finishes

BLP, BZP, WHP, SAP, BLW, BZW, WHW, VER

Premium Finishes

CMG, SMG, RMG, AMG, TXF, BCM, BGE, WCP, OCP, HUG, ABP, BPP, SDS,

WIR, CAP, CRM, AQW, NBP

Other - RAL

RAL

Other - Custom Color

CUS

NOTE: Not all configurations may be compatible with one another. Please configure the product for specific 2D, Photometry, Downloads, Spec Sheet and Compatible mountings and power supplies.

WARNING: This is a remote driver product. Please check "Mountings With A Power Supply" or "Power Supplies" to order remote driver separately. (IMPORTANT: Driver wattage MUST match selected fixture wattage. Example: 12W Light Source = 12W Driver)

ALPINE - Ceiling Mount - Remote Driver - LED Color Tuning - Asymmetrical Optics

Features



Anti-condensation vent allows moisture to exit the fixture but never enter in



Lens factory adhered to fixture cap providing hermetically sealed optical compartment



Manufactured in the USA with sustainable processes



Water-tight anti-siphon plug prevents moisture ingress from wireways



Secured with tamper-resistant, stainless steel hardware



Easily replaceable modular components reduce waste and extend fixture life



Slip fit cap & high temp. silicone 'O' ring provides reliable water-tight seal



Solid billet fixture body provides unmatched durability and heat management

Technical

Driver: Remote Driver

Light Source (Type): LED Color Tuning

Material: Aluminum

CCT (K): 1650 - 8000

CRI: 90

Input Power (W): 42

Delivered Lumens (lm): Array

Mount: Surface Mount

Style: Cap C - Flush Lens, Cap E - 90°

Version: Asymmetrical Optics

Lens: Soft Focus

Wiring Length: Standard

Finish: Standard Finishes, Premium Finishes, Other - RAL, Other - Custom Color

Body: Unibody design with enclosed, water-proof wireway, integral heat sink, fully machined from solid billet, anti-condensation and corrosion vent equalizes fixture pressure and eliminates potential for damage to internal components.

Material Detail: Furnished in copper-free aluminum (6061-T6).

Light Source Detail: LED Color Tuning

Optics: Batwing Optics control light for even illumination with superior spacing. They deliver wide-angle distribution, minimize glare above 60°, and balance spacing with visual comfort. Achieve uniform lighting and save energy by using fewer fixtures.

Hardware: Tamper-resistant, stainless steel hardware. Hardware is black oxide treated for additional corrosion resistance.

Sealing: 'O' Ring provides water-tight seal., Anti-condensation and corrosion vent equalizes fixture pressure and eliminates potential for damage to internal components.

Finish Detail: StarGuard, our 15-stage chromate-free process, cleans and conversion coats aluminum components prior to application of Class 'A' TGIC polyester powder coating. It is RoHS compliant.

Warranty: 5-year limited warranty.

WARNING: This is a remote driver product. Please check "Mountings With A Power Supply" or "Power Supplies" to order remote driver separately. (IMPORTANT: Driver wattage MUST match selected fixture wattage. Example: 12W Light Source = 12W Driver)

ALPINE - Ceiling Mount - Remote Driver - LED Color Tuning - Asymmetrical Optics

Finishes

STANDARD FINISHES



PREMIUM FINISHES



OTHER - RAL



OTHER - CUSTOM COLOR



ALPINE - Ceiling Mount - Remote Driver - LED Color Tuning - Asymmetrical Optics

Light Source

Light Source	Optic	Beam Angle	CCT (K)	CRI	R9	Input Power (W)	Delivered Lumens (Lm)	CBCP
C26	BW - Batwing	60	1650 - 8000	90	>50	42		