

# ALPINE - Ceiling Mount - Remote Driver - LED Color Tuning - Symmetrical Optics

TEMPORARILY UNAVAILABLE



IP66



### Downloads

- Product Images (.zip)
- Technical Drawing (.zip)
- 2D (.dwg)
- 2D (.dxf)
- IES Files (.zip)
- BIM - Revit (.zip)
- Installation Instructions (.pdf)

### Product Variant Examples

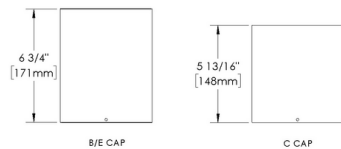
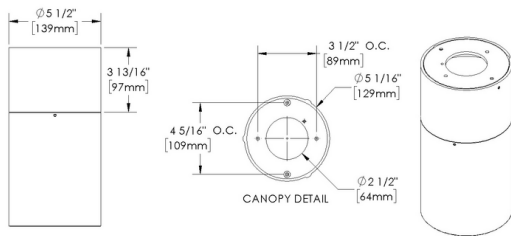

# ALPINE - Ceiling Mount - Remote Driver - LED Color Tuning - Symmetrical Optics

## Available Logic & Configurations

**AP-** 01   **CM-** 02   **RMD-** 03   **LCT-** 04   **AL-** 05   **SM-** 06B   **\_\_\_-** 06C   **OSYM-** 06D

**01 SERIES**

**AP** - ALPINE

**02 CATEGORY**

**CM** - Ceiling Mount

**03 DRIVER**

**RMD** - Remote Driver

**04 LIGHT SOURCE (TYPE)**

**LCT** - LED Color Tuning

**05 MATERIAL**

**AL** - Aluminum

**06B MOUNT**

**SM** - Surface Mount

**06C STYLE**

**CC** - Cap C - Flush Lens

**CE** - Cap E - 90°

**06D VERSION**

**OSYM** - Symmetrical Optics

**C26-** 07   **\_\_\_-** 08   **12-** 10A   **\_\_\_-** 10B   **WL00-** 11   **\_\_\_-** 12

**07 LIGHT SOURCE**

**C26** - 1650-8000K + Saturation and Hue CRI95+ - 42W

**08 OPTIC**

**SP** - Spot (16°)

**MFL** - Medium Flood (34°)

**FL** - Flood (41°)

**10A LENS**

**12** - Soft Focus

**10B SHIELDING**

**00** - Not included (Standard)

**11** - Honeycomb Baffle

**11 WIRING LENGTH**

**WL00** - Standard

**12 FINISH**

Standard Finishes

**BLP, BZP, WHP, SAP, BLW, BZW, WHW, VER**

Premium Finishes

**CMG, SMG, RMG, AMG, TXF, BCM, BGE, WCP, OCP, HUG, ABP, BPP, SDS,**

**WIR, CAP, CRM, AQW, NBP**

Other - RAL

**RAL**

Other - Custom Color

**CUS**

**NOTE:** Not all configurations may be compatible with one another. Please configure the product for specific 2D, Photometry, Downloads, Spec Sheet and Compatible mountings and power supplies.

**WARNING: This is a remote driver product. Please check "Mountings With A Power Supply" or "Power Supplies" to order remote driver separately. (IMPORTANT: Driver wattage MUST match selected fixture wattage. Example: 12W Light Source = 12W Driver)**

# ALPINE - Ceiling Mount - Remote Driver - LED Color Tuning - Symmetrical Optics

## Features



Anti-condensation vent allows moisture to exit the fixture but never enter in



Lens factory adhered to fixture cap providing hermetically sealed optical compartment



Manufactured in the USA with sustainable processes



Water-tight anti-siphon plug prevents moisture ingress from wireways



Secured with tamper-resistant, stainless steel hardware



Easily replaceable modular components reduce waste and extend fixture life



Slip fit cap & high temp. silicone 'O' ring provides reliable water-tight seal

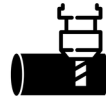

Solid billet fixture body provides unmatched durability and heat management

## Technical

**Driver:** Remote Driver

**Light Source (Type):** LED Color Tuning

**Material:** Aluminum

**CCT (K):** 2700, 3000, 4000, 1650 - 8000

**CRI:** 95, 90

**Input Power (W):** 42

**Delivered Lumens (lm):** 787 - 1345

**Beam Angle (°):** 16, 34, 41

**Mount:** Surface Mount

**Style:** Cap C - Flush Lens, Cap E - 90°

**Version:** Symmetrical Optics

**Lens:** Soft Focus

**Shielding:** Not included (Standard), Honeycomb Baffle

**Wiring Length:** Standard

**Finish:** Standard Finishes, Premium Finishes, Other - RAL, Other - Custom Color

**Body:** Unibody design with enclosed, water-proof wireway, integral heat sink, fully machined from solid billet, anti-condensation and corrosion vent equalizes fixture pressure and eliminates potential for damage to internal components.

**Material Detail:** Furnished in copper-free aluminum (6061-T6).

**Light Source Detail:** LED Color Tuning

**Optics:** Interchangeable optics permit changes in the field.

**Hardware:** Tamper-resistant, stainless steel hardware.

**Sealing:** 'O' Ring provides water-tight seal., Anti-condensation and corrosion vent equalizes fixture pressure and eliminates potential for damage to internal components.

**Finish Detail:** StarGuard, our 15-stage chromate-free process, cleans and conversion coats aluminum components prior to application of Class 'A' TGIC polyester powder coating. It is RoHS compliant.

**Warranty:** 5-year limited warranty.

**WARNING: This is a remote driver product. Please check "Mountings With A Power Supply" or "Power Supplies" to order remote driver separately. (IMPORTANT: Driver wattage MUST match selected fixture wattage. Example: 12W Light Source = 12W Driver)**

# ALPINE - Ceiling Mount - Remote Driver - LED Color Tuning - Symmetrical Optics

## Finishes

### STANDARD FINISHES



[BLP] Satin Black



[BZP] Satin Bronze



[WHP] Satin White



[SAP] Satin Aluminum



[BLW] Black Wrinkle



[BZW] Bronze Wrinkle



[WHW] White Wrinkle



[VER] Verde

### PREMIUM FINISHES



[CMG] Cascade Mountain Granite



[SMG] Sierra Mountain Granite



[RMG] Rocky Mountain Granite



[AMG] Aleutian Mountain Granite



[TXF] Textured Forest



[BCM] Black Chrome



[BGE] Beige



[WCP] Weathered Copper



[OCP] Old Copper



[HUG] Hunter Green



[ABP] Antique Brass Powder



[BPP] Brown Patina Powder



[SDS] Sonoran Desert Sandstone



[WIR] Weathered Iron



[CAP] Clear Anodized Powder



[CRM] Cream



[AQW] Antique White



[NBP] Natural Brass Powder

### OTHER - RAL



[RAL] RAL Color

### OTHER - CUSTOM COLOR



[CUS] Custom Color

# ALPINE - Ceiling Mount - Remote Driver - LED Color Tuning - Symmetrical Optics

## Light Source

Light Source	Optic	Beam Angle	CCT (K)	CRI	R9	Input Power (W)	Delivered Lumens (Lm)	CBCP
C26	SP - Spot	16	1650 - 8000	90	>50	42		
C26	SP - Spot	16	2700	95	>50	42	834	5824
C26	SP - Spot	16	3000	95	>50	42	968	6763
C26	SP - Spot	16	4000	95	>50	42	1345	9393
C26	MFL - Medium Flood	34	1650 - 8000	90	>50	42		
C26	MFL - Medium Flood	34	2700	95	>50	42	801	2113
C26	MFL - Medium Flood	34	3000	95	>50	42	930	2454
C26	MFL - Medium Flood	34	4000	95	>50	42	1292	3408
C26	FL - Flood	41	1650 - 8000	90	>50	42		
C26	FL - Flood	41	2700	95	>50	42	787	1611
C26	FL - Flood	41	3000	95	>50	42	914	2076
C26	FL - Flood	41	4000	95	>50	42	1269	2598