

ALPINE - Ceiling Mount - Line Voltage - LED COB - Symmetrical Optics

NEW



IP66



Downloads

- Product Images (.zip)
- Technical Drawing (.zip)
- 2D (.dwg)
- 2D (.dxf)
- IES Files (.zip)
- BIM - Revit (.zip)
- Installation Instructions (.pdf)

Product Variant Examples

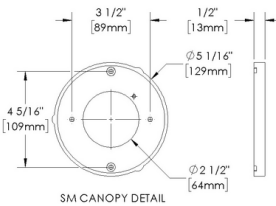
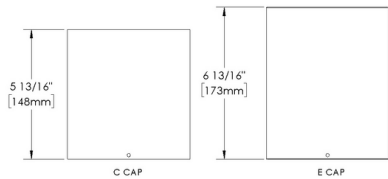
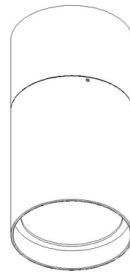
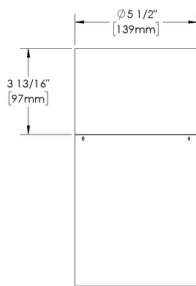

ALPINE - Ceiling Mount - Line Voltage - LED COB - Symmetrical Optics

Available Logic & Configurations

AP- 01 **CM-** 02 **LID-** 03 **LCB-** 04 **AL-** 05 **SM-** 06B **---** 06C **---** 06D **---** 06E

- 01 SERIES**
AP - ALPINE
- 02 CATEGORY**
CM - Ceiling Mount
- 03 DRIVER**
LID - Line Voltage
- 04 LIGHT SOURCE (TYPE)**
LCB - LED COB

- 05 MATERIAL**
AL - Aluminum
- 06B MOUNT**
SM - Surface Mount
- 06C STYLE**
CC - Cap C - Flush Lens
CE - Cap E - 90°
- 06D VERSION**
OSYM-ONAR - Symmetrical Optics - Narrow Optic
OSYM-OOTH - Symmetrical Optics - Other Optics
- 06E INPUT VOLTAGE**
120 - 120V
277 - 277V

--- 07 **---** 08 **---** 09 **---** 10B **WL00-** 11 **---** 12

- 07 LIGHT SOURCE**
x43 - 2700K CRI80 - 34W
x44 - 3000K CRI80 - 34W
x45 - 4000K CRI80 - 34W
x46 - 2700K CRI80 - 42W (2707 - 3817 lm)
x47 - 3000K CRI80 - 42W (2888 - 4071 lm)
x48 - 4000K CRI80 - 42W (3008 - 4241 lm)
- 08 OPTIC**
NFL - Narrow Flood (25°)
FL - Flood (40°)
WFL - Wide Flood (60°)

- 09 CONTROL**
ELV - ELV Dimming (For use with Electronic Low Voltage Dimmer. 120V only.)
INC - INC Dimming (For use with Incandescent Dimmer. 120V only.)
010 - 0-10V (120V,277V)
- 10B SHIELDING**
00 - Not included (Standard)
11 - Honeycomb Baffle
- 11 WIRING LENGTH**
WL00 - Standard
- 12 FINISH**
Standard Finishes
BLP, BZP, WHP, SAP, BLW, BZW, WHW, VER
Premium Finishes
CMG, SMG, RMG, AMG, TXF, BCM, BGE, WCP, OCP, HUG, ABP, BPP, SDS,
WIR, CAP, CRM, AQW, NBP
Other - RAL
RAL
Other - Custom Color
CUS

NOTE: Not all configurations may be compatible with one another. Please configure the product for specific 2D, Photometry, Downloads, Spec Sheet and Compatible mountings and power supplies.

ALPINE - Ceiling Mount - Line Voltage - LED COB - Symmetrical Optics

Features



Anti-condensation vent allows moisture to exit the fixture but never enter in



Lens factory adhered to fixture cap providing hermetically sealed optical compartment



Manufactured in the USA with sustainable processes



Water-tight anti-siphon plug prevents moisture ingress from wireways



Secured with tamper-resistant, stainless steel hardware



Easily replaceable modular components reduce waste and extend fixture life



Slip fit cap & high temp. silicone 'O' ring provides reliable water-tight seal

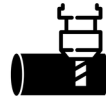

Solid billet fixture body provides unmatched durability and heat management

Technical

Driver: Line Voltage

Light Source (Type): LED COB

Material: Aluminum

CCT (K): 2700, 3000, 4000

CRI: 80

Input Power (W): 34, 42

Delivered Lumens (lm): 1860 - 4241

Beam Angle (°): 25, 40, 60

Control: 0-10V (120V, 277V), ELV Dimming (For use with Electronic Low Voltage Dimmer. 120V only.), INC Dimming (For use with Incandescent Dimmer. 120V only.)

Mount: Surface Mount

Style: Cap C - Flush Lens, Cap E - 90°

Version: Symmetrical Optics - Narrow Optic, Symmetrical Optics - Other Optics

Input Voltage: 120V, 277V

Shielding: Not included (Standard), Honeycomb Baffle

Wiring Length: Standard

Finish: Standard Finishes, Premium Finishes, Other - RAL, Other - Custom Color

Body: Unibody design with enclosed, water-proof wireway, integral heat sink, fully machined from solid billet, anti-condensation and corrosion vent equalizes fixture pressure and eliminates potential for damage to internal components.

Material Detail: Furnished in copper-free aluminum (6061-T6).

Light Source Detail: COB (Chip on Board) technology and modular design with electrical quick disconnects.

Optics: Interchangeable optics permit changes in the field.

Hardware: Tamper-resistant, stainless steel hardware.

Sealing: 'O' Ring provides water-tight seal., Anti-condensation and corrosion vent equalizes fixture pressure and eliminates potential for damage to internal components.

Finish Detail: StarGuard, our 15-stage chromate-free process, cleans and conversion coats aluminum components prior to application of Class 'A' TGIC polyester powder coating. It is RoHS compliant.

Warranty: 5-year limited warranty.

ALPINE - Ceiling Mount - Line Voltage - LED COB - Symmetrical Optics

Finishes

STANDARD FINISHES



PREMIUM FINISHES



OTHER - RAL



OTHER - CUSTOM COLOR



ALPINE - Ceiling Mount - Line Voltage - LED COB - Symmetrical Optics

Light Source

Light Source	Optic	Beam Angle	CCT (K)	CRI	R9	Input Power (W)	Delivered Lumens (Lm)	CBCP
x43	NFL - Narrow Flood	25	2700	80	>15	34	1915	5435
x43	FL - Flood	40	2700	80	>15	34	2212	3840
x43	WFL - Wide Flood	60	2700	80	>15	34	1860	2697
x44	NFL - Narrow Flood	25	3000	80	>15	34	1998	5672
x44	FL - Flood	40	3000	80	>15	34	2308	4007
x44	WFL - Wide Flood	60	3000	80	>15	34	1941	2814
x45	NFL - Narrow Flood	25	4000	80	>15	34	2091	5908
x45	FL - Flood	40	4000	80	>15	34	2418	4174
x45	WFL - Wide Flood	60	4000	80	>15	34	2034	2931
x46	NFL - Narrow Flood	25	2700	80	>15	42	3817	15755
x46	FL - Flood	40	2700	80	>15	42	3288	4985
x46	WFL - Wide Flood	60	2700	80	>15	42	2707	3386
x47	NFL - Narrow Flood	25	3000	80	>15	42	4071	16805
x47	FL - Flood	40	3000	80	>15	42	3507	5317
x47	WFL - Wide Flood	60	3000	80	>15	42	2888	3612
x48	NFL - Narrow Flood	25	4000	80	>15	42	4241	17505
x48	FL - Flood	40	4000	80	>15	42	3653	5539
x48	WFL - Wide Flood	60	4000	80	>15	42	3008	3725