

# NITE STAR - In-grade - Low Voltage - LED High-Power - Surface Mount



IP66

**Downloads**

Product Images (.zip)

Technical Drawing (.zip)

BIM - Revit (.zip)

Installation Instructions (.pdf)

**Product Variant Examples**

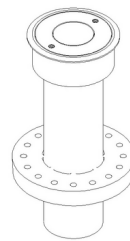
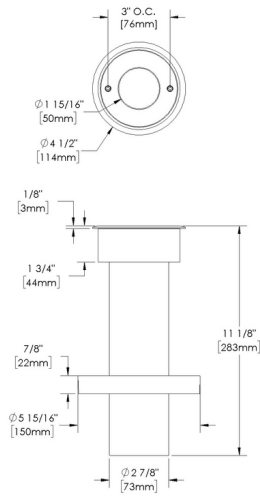

# NITE STAR - In-grade - Low Voltage - LED High-Power - Surface Mount

## Available Logic & Configurations

**NS-** 01    **IN-** 02    **LOD-** 03    **LHP-** 04    **-** 05    **FSM-** 06B

**01 SERIES**

**NS** - NITE STAR

**02 CATEGORY**

**IN** - In-grade

**03 DRIVER**

**LOD** - Low Voltage

**04 LIGHT SOURCE (TYPE)**

**LHP** - LED High-Power

**-** 07    **-** 10A    **-** 10B    **-** 11    **-** 12

**07 LIGHT SOURCE**

- e64** - 2700K CRI80 - 7W (343 - 456 lm)
- e65** - 3000K CRI80 - 7W (406 - 466 lm)
- e66** - 4000K CRI80 - 7W (456 - 524 lm)
- e74** - Amber - 7W (260 - 299 lm)
- e79** - 2700K CRI90 - 7W
- e80** - 3000K CRI90 - 7W
- e81** - 3500K CRI80 - 7W

**05 MATERIAL**

- AL** - Aluminum
- BR** - Brass
- SS** - Stainless Steel

**06B MOUNT**

**FSM** - Faceplate Surface Mount

**10A LENS**

- 12** - Soft Focus
- 13** - Rectilinear

**10B SHIELDING**

- 00** - Not included (Standard)
- 11** - Honeycomb Baffle

**11 WIRING LENGTH**

- WL00** - Standard
- WL25** - 25 Ft Leads

**12 FINISH**

- Standard Finishes
- BLP, BZP, WHP, SAP, BLW, BZW, WHW, VER**
- Premium Finishes
- CMG, SMG, RMG, AMG, TXF, BCM, BGE, WCP, OCP, HUG, ABP, BPP, SDS, WIR, CAP, CRM, AQW, NBP**
- Other - RAL
- RAL**
- Other - Custom Color
- CUS**
- Brass Finishes
- MAB, POB, MIT**
- Stainless Steel Finishes
- MAS, POS**

**NOTE:** Not all configurations may be compatible with one another. Please configure the product for specific 2D, Photometry, Downloads, Spec Sheet and Compatible mountings and power supplies.

# NITE STAR - In-grade - Low Voltage - LED High-Power - Surface Mount

## Features



Lens factory adhered to fixture cap providing hermetically sealed optical compartment



Secured with flush, countersunk tamper resistant hardware



Machined solid billet faceplate provides unmatched strength and durability



Manufactured in the USA with sustainable processes



Water-tight anti-siphon plug prevents moisture ingress from wireways



Easily replaceable modular components reduce waste and extend fixture life



Solid billet fixture body provides unmatched durability and heat management

**WARNING: This is a low voltage product. Please check "Mountings With A Power Supply" or "Power Supplies" to order remote transformer separately.**

## Technical

**Driver:** Low Voltage

**Light Source (Type):** LED High-Power

**Material:** Aluminum, Brass, Stainless Steel

**Input Power (W):** 7

**Delivered Lumens (lm):** Array

**Mount:** Faceplate Surface Mount

**Lens:** Soft Focus, Rectilinear

**Shielding:** Not included (Standard), Honeycomb Baffle

**Wiring Length:** Standard, 25 Ft Leads

**Finish:** Standard Finishes, Premium Finishes, Other - RAL, Other - Custom Color, Brass Finishes, Stainless Steel Finishes

**Body:** Unibody design with enclosed, water-proof wireway, integral heat sink, fully machined from solid billet, anti-condensation and corrosion vent equalizes fixture pressure and eliminates potential for damage to internal components.

**Material Detail:** Furnished in stainless steel (304), Furnished in brass (360), Furnished in copper-free aluminum (6061-T6).

**Light Source Detail:** High power LEDs modular design with electrical disconnects.

**Optics:** Interchangeable optics permit changes in the field.

**Hardware:** Tamper-resistant, stainless steel hardware. Hardware is black oxide treated for additional corrosion resistance.

**Sealing:** 'O' Ring provides water-tight seal., Anti-condensation and corrosion vent equalizes fixture pressure and eliminates potential for damage to internal components.

**Note:** Adjust-e-Lume, an LED board feature, allows for dynamic lumen response at the individual fixture. Indexed (100% to 25% nom.) lumen output. Maintains output at desired level or may be changed (A9 to A1). Standard preset from the factory is A9 (100%).

**Finish Detail:** Powder coat or metal finish options available for brass material., Metal finish option only for stainless steel material., StarGuard, our 15-stage chromate-free process, cleans and conversion coats aluminum components prior to application of Class 'A' TGIC polyester powder coating. It is RoHS compliant.

**Warranty:** 5-year limited warranty.

# NITE STAR - In-grade - Low Voltage - LED High-Power - Surface Mount

## Finishes

### STANDARD FINISHES



[BLP] Satin Black



[BZP] Satin Bronze



[WHP] Satin White



[SAP] Satin Aluminum



[BLW] Black Wrinkle



[BZW] Bronze Wrinkle



[WHW] White Wrinkle



[VER] Verde

### PREMIUM FINISHES



[CMG] Cascade Mountain Granite



[SMG] Sierra Mountain Granite



[RMG] Rocky Mountain Granite



[AMG] Aleutian Mountain Granite



[TXF] Textured Forest



[BCM] Black Chrome



[BGE] Beige



[WCP] Weathered Copper



[OCP] Old Copper



[HUG] Hunter Green



[ABP] Antique Brass Powder



[BPP] Brown Patina Powder



[SDS] Sonoran Desert Sandstone



[WIR] Weathered Iron



[CAP] Clear Anodized Powder



[CRM] Cream



[AQW] Antique White



[NBP] Natural Brass Powder

### OTHER - RAL



[RAL] RAL Color

### OTHER - CUSTOM COLOR



[CUS] Custom Color

### BRASS FINISHES



[MAB] Machined (Brass)



[POB] Polished (Brass)



[MIT] Mitique

### STAINLESS STEEL FINISHES



[MAS] Machined (Stainless Steel)



[POS] Polished (Stainless Steel)