

ORION - Floodlight - Line Voltage - LED High-Power

UPGRADED



Downloads

- Product Images (.zip)
- Technical Drawing (.zip)
- 2D (.dwg)
- 2D (.dxf)
- IES Files (.zip)
- BIM - Revit (.zip)
- Installation Instructions (.pdf)

Product Variant Examples

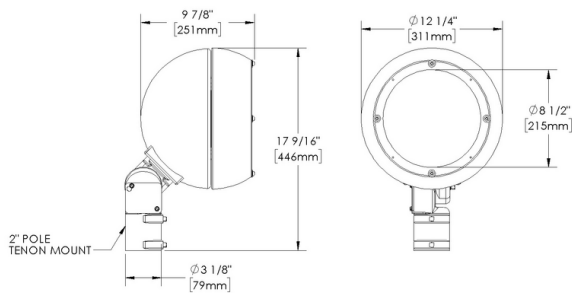
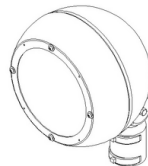

ORION - Floodlight - Line Voltage - LED High-Power

Available Logic & Configurations

OR- **FL-** **LID-** **LHP-** **AL-** **___-** **___-** **D12-**
 01 02 03 04 05 06B 06C 06F

01 SERIES

OR - ORION

02 CATEGORY

FL - Floodlight

03 DRIVER

LID - Line Voltage

04 LIGHT SOURCE (TYPE)

LHP - LED High-Power

05 MATERIAL

AL - Aluminum

06B MOUNT

KS2 - Knuckle Slipfitter - Orion

YM2 - Yoke Mount - Orion

06C STYLE

S00 - No Shield

SEL - Egg Crate Louver Shield (external)

SFL - Fixed Louver Shield (external)

SLX - Lexan Shield

SS3 - 3 Sided Shield

SS4 - 4 Sided Shield

STO - Top Shield

06F SIZE

D12 - Diameter: 12"

___- **___-** **010-** **WL00-** **___-** **___-**
 07 08 09 11 12 14

07 LIGHT SOURCE

e114 - 2700K CRI80 - 90W (7190 - 9742 lm)

e115 - 3000K CRI80 - 90W (9014 - 10614 lm)

e116 - 4000K CRI80 - 90W (9191 - 10823 lm)

e117 - 5000K CRI80 - 90W (8341 - 11273 lm)

e119 - 3500K CRI80 - 90W (9448 - 11126 lm)

08 OPTIC

VNSP - Very Narrow Spot (7.5°)

SP - Spot (16.3°)

MFL - Medium Flood (37°)

FL - Flood (46.8°)

WFL - Wide Flood (58.1°)

ASY - Asymmetrical (86.2 x 74.5°)

09 CONTROL

010 - 0-10V (120V,277V)

11 WIRING LENGTH

WL00 - Standard

12 FINISH

Standard Finishes

BLP, BZP, WHP, SAP, BLW, BZW, WHW, VER

Premium Finishes

CMG, SMG, RMG, AMG, TXF, BCM, BGE, WCP, OCP, HUG, ABP, BPP, SDS,

WIR, CAP, CRM, AQW, NBP

Other - RAL

RAL

Other - Custom Color

CUS

14 ACCESSORY

KSMP - Knuckle Slipfitter with Mounting Plate

KSWA - Knuckle Slipfitter with Wall Pole Mounting Arm

YMHS - Yoke Mount with Horizontal Sector

YMMA - Yoke Mount Wall Pole Mounting Arm

YMMP - Yoke Mount with Slipfitter and Mounting Plate

YMMS - Yoke Mount with Mounting Stud

YMSF - Yoke Mount with Slipfitter

NOTE: Not all configurations may be compatible with one another. Please configure the product for specific 2D, Photometry, Downloads, Spec Sheet and Compatible mountings and power supplies.

ORION - Floodlight - Line Voltage - LED High-Power

Features



Manufactured in the USA with sustainable processes



Easily replaceable modular components reduce waste and extend fixture life

Technical

Driver: Line Voltage

Light Source (Type): LED High-Power

Material: Aluminum

CCT (K): 2700, 3500, 3000, 4000, 5000

CRI: 80, 70

Input Power (W): 90

Delivered Lumens (lm): 7190 - 11273

Beam Angle (°): 7.5, 16.3, 37, 46.8, 58.1, 86.2 x 74.5

Control: 0-10V (120V,277V)

Mount: Knuckle Slipfitter - Orion, Yoke Mount - Orion

Style: No Shield, 3 Sided Shield, 4 Sided Shield, Top Shield, Lexan Shield, Fixed Louver Shield (external), Egg Crate Louver Shield (external)

Size: Diameter: 12"

Wiring Length: Standard

Finish: Standard Finishes, Premium Finishes, Other - RAL, Other - Custom Color

Accessory: Knuckle Slipfitter with Mounting Plate, Knuckle Slipfitter with Wall Pole Mounting Arm, Yoke Mount with Horizontal Sector, Yoke Mount Wall Pole Mounting Arm, Yoke Mount with Slipfitter and Mounting Plate, Yoke Mount with Mounting Stud, Yoke Mount with Slipfitter

Material Detail: Furnished in copper-free aluminum (6061-T6).

Aiming: Knuckle Slipfitter or Yoke Mount provides vertical aiming

Light Source Detail: High power LEDs modular design with electrical disconnects.

Optics: Interchangeable optics permit changes in the field.

Hardware: Tamper-resistant, stainless steel hardware.

Sealing: Concealed, single piece high temperature closed cell silicone gasket between housing and door frame.

Finish Detail: StarGuard, our 15-stage chromate-free process, cleans and conversion coats aluminum components prior to application of Class 'A' TGIC polyester powder coating. It is RoHS compliant.

Warranty: 5-year limited warranty.

ORION - Floodlight - Line Voltage - LED High-Power

Finishes

STANDARD FINISHES



PREMIUM FINISHES

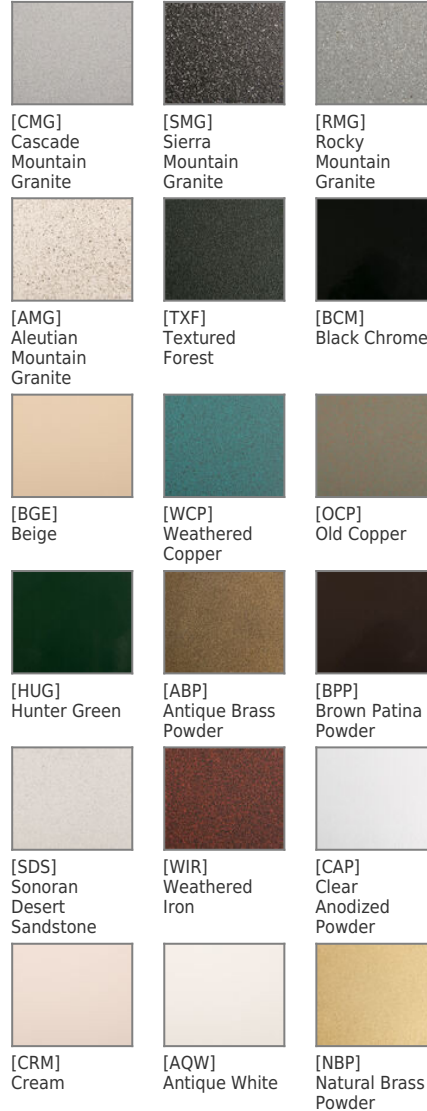

OTHER - RAL



OTHER - CUSTOM COLOR

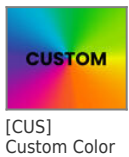

ORION - Floodlight - Line Voltage - LED High-Power

Light Source

| Light Source | Optic | Beam Angle | CCT (K) | CRI | R9 | Input Power (W) | Delivered Lumens (Lm) | CBCP |
|--------------|-------------------------|-------------|---------|-----|-----|-----------------|-----------------------|--------|
| e114 | VNSP - Very Narrow Spot | 7.5 | 2700 | 80 | >15 | 90 | 8273 | 180605 |
| e114 | SP - Spot | 16.3 | 2700 | 80 | >15 | 90 | 8722 | 75103 |
| e114 | MFL - Medium Flood | 37 | 2700 | 80 | >15 | 90 | 9742 | 18042 |
| e114 | FL - Flood | 46.8 | 2700 | 80 | >15 | 90 | 8773 | 15462 |
| e114 | WFL - Wide Flood | 58.1 | 2700 | 80 | >15 | 90 | 9178 | 7825 |
| e114 | ASY - Asymmetrical | 86.2 x 74.5 | 2700 | 80 | >15 | 90 | 9105 | 6130 |
| e115 | VNSP - Very Narrow Spot | 7.5 | 3000 | 80 | >15 | 90 | 9014 | 196786 |
| e115 | SP - Spot | 16.3 | 3000 | 80 | >15 | 90 | 9503 | 81832 |
| e115 | MFL - Medium Flood | 37 | 3000 | 80 | >15 | 90 | 10614 | 19659 |
| e115 | FL - Flood | 46.8 | 3000 | 80 | >15 | 90 | 9559 | 16848 |
| e115 | WFL - Wide Flood | 58.1 | 3000 | 80 | >15 | 90 | 10001 | 8526 |
| e115 | ASY - Asymmetrical | 86.2 x 74.5 | 3000 | 80 | >15 | 90 | 9921 | 6679 |
| e116 | VNSP - Very Narrow Spot | 7.5 | 4000 | 80 | >15 | 90 | 9191 | 200644 |
| e116 | SP - Spot | 16.3 | 4000 | 80 | >15 | 90 | 9689 | 83436 |
| e116 | MFL - Medium Flood | 37 | 4000 | 80 | >15 | 90 | 10823 | 20044 |
| e116 | FL - Flood | 46.8 | 4000 | 80 | >15 | 90 | 9746 | 17178 |
| e116 | WFL - Wide Flood | 58.1 | 4000 | 80 | >15 | 90 | 10197 | 8693 |
| e116 | ASY - Asymmetrical | 86.2 x 74.5 | 4000 | 80 | >15 | 90 | 10115 | 6810 |
| e117 | VNSP - Very Narrow Spot | 7.5 | 5000 | 70 | >50 | 90 | 9573 | 208996 |
| e117 | SP - Spot | 16.3 | 5000 | 70 | >50 | 90 | 10093 | 86909 |
| e117 | MFL - Medium Flood | 37 | 5000 | 70 | >50 | 90 | 11273 | 20879 |
| e117 | FL - Flood | 46.8 | 5000 | 70 | >50 | 90 | 10152 | 17893 |
| e117 | WFL - Wide Flood | 58.1 | 5000 | 70 | >50 | 90 | 10621 | 9055 |
| e117 | ASY - Asymmetrical | 86.2 x 74.5 | 5000 | 70 | >50 | 90 | 10536 | 7094 |
| e119 | VNSP - Very Narrow Spot | 7.5 | 3500 | 80 | >15 | 90 | 9448 | 206272 |
| e119 | SP - Spot | 16.3 | 3500 | 80 | >15 | 90 | 9961 | 85777 |
| e119 | MFL - Medium Flood | 37 | 3500 | 80 | >15 | 90 | 11126 | 20606 |
| e119 | FL - Flood | 46.8 | 3500 | 80 | >15 | 90 | 10020 | 17660 |
| e119 | WFL - Wide Flood | 58.1 | 3500 | 80 | >15 | 90 | 10483 | 8937 |
| e119 | ASY - Asymmetrical | 86.2 x 74.5 | 3500 | 80 | >15 | 90 | 10399 | 7001 |
| e114 | VNSP - Very Narrow Spot | 7.5 | 2700 | 80 | >15 | 90 | 7190 | 139532 |
| e117 | VNSP - Very Narrow Spot | 7.5 | 5000 | 70 | >50 | 90 | 8341 | 161869 |