

Discontinued



# STEP STAR - Wall Recessed - Line Voltage - Lamp MR16 Gu10 - Round - Core Drill - Faceplate: Louvered - Pattern C

DISCONTINUED

Downloads  
2D (.dwg)  
2D (.dxf)  
BIM - Revit (.zip)  
Installation Instructions (.pdf)

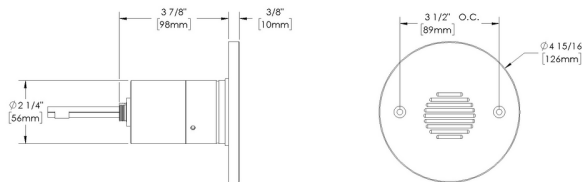
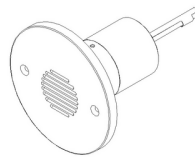

AMERICAN MADE + EMPLOYEE OWNED | 40429 Brickyard Drive, Madera, CA 93636 | +1 (559) 438-5800 | info@bklighting.com | bklighting.com

Copyright © B-K Lighting, Inc. This document contains proprietary information of B-K Lighting, inc. and its receipt or possession does not convey any rights to reproduce, disclose its contents, or to manufacture, use or sell anything it may describe.

Technical information is subject to change at the discretion of B-K Lighting Inc. For the most current technical data, please refer to bklighting.com

Discontinued



# STEP STAR - Wall Recessed - Line Voltage - Lamp MR16 Gu10 - Round - Core Drill - Faceplate: Louvered - Pattern C

## Available Logic & Configurations

**SS-** **WR-** **LID-** **LAG10-** **\_\_\_-** **RO-** **CD-** **FLDC-**  
01 02 03 04 05 06A 06B 06C

**01 SERIES**

**SS** - STEP STAR

**02 CATEGORY**

**WR** - Discontinued

**03 DRIVER**

**LID** - Line Voltage

**04 LIGHT SOURCE (TYPE)**

**LAG10** - Lamp MR16 Gu10

**05 MATERIAL**

**AL** - Aluminum

**BR** - Brass

**SS** - Stainless Steel

**06A SHAPE**

**RO** - Round

**06B MOUNT**

**CD** - Core Drill

**06C STYLE**

**FLDC** - Faceplate: Louvered - Pattern C - 30° Angle - Round

**NOTE:** Not all configurations may be compatible with one another. Please configure the product for specific 2D, Photometry, Downloads, Spec Sheet and Compatible mountings and power supplies.

Discontinued



# STEP STAR - Wall Recessed - Line Voltage - Lamp MR16 Gu10 - Round - Core Drill - Faceplate: Louvered - Pattern C

## Features



Lens factory adhered to fixture cap providing hermetically sealed optical compartment



Secured with flush, countersunk tamper resistant hardware



Machined solid billet faceplate provides unmatched strength and durability



Manufactured in the USA with sustainable processes



Water-tight anti-siphon plug prevents moisture ingress from wireways



Easily replaceable modular components reduce waste and extend fixture life

## Technical

Delivered Lumens (lm): Array