

MICRO STEP STAR - Wall Recessed - Low Voltage - LED High-Power - Round - Core Drill - Faceplate: Standard - Pattern B - Micro



IP66

Downloads

[Product Images \(.zip\)](#)

[Technical Drawing \(.zip\)](#)

[2D \(.dwg\)](#)

[2D \(.dxf\)](#)

[BIM - Revit \(.zip\)](#)

[Installation Instructions \(.pdf\)](#)

Product Variant Examples

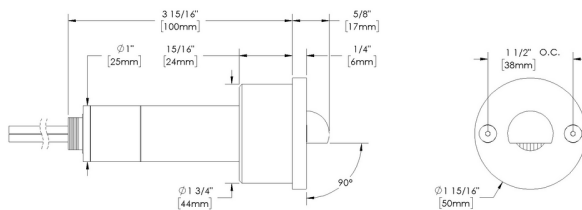
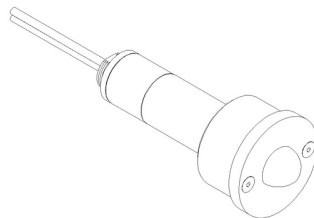

MICRO STEP STAR - Wall Recessed - Low Voltage - LED High-Power - Round - Core Drill - Faceplate: Standard - Pattern B - Micro

Available Logic & Configurations

SS- 01	WR- 02	LOD- 03	LHP- 04	- 05	RO- 06A	CD- 06B	FSDB- 06C	MIC- 06D
01 SERIES SS - STEP STAR 02 CATEGORY WR - Wall Recessed 03 DRIVER LOD - Low Voltage 04 LIGHT SOURCE (TYPE) LHP - LED High-Power				05 MATERIAL AL - Aluminum BR - Brass SS - Stainless Steel 06A SHAPE RO - Round 06B MOUNT CD - Core Drill 06C STYLE FSDB - Faceplate: Standard - Pattern B - 90° Angle - Round 06D VERSION MIC - Micro				
07 LIGHT SOURCE e70 - 2700K CRI80 - 3W (20 - 20 lm) e71 - 3000K CRI80 - 3W (21 - 21 lm) e72 - 4000K CRI80 - 3W (24 - 24 lm) e73 - Amber - 3W e85 - 2700K CRI90 - 3W e86 - 3000K CRI90 - 3W e87 - 3500K CRI80 - 3W				11 WIRING LENGTH WL00 - Standard WL25 - 25 Ft Leads 12 FINISH Standard Finishes BLP, BZP, WHP, SAP, BLW, BZW, WHW, VER Premium Finishes CMG, SMG, RMG, AMG, TXF, BCM, BGE, WCP, OCP, HUG, ABP, BPP, SDS, WIR, CAP, CRM, AQW, NBP Other - RAL RAL Other - Custom Color CUS Brass Finishes MAB, POB, MIT Stainless Steel Finishes MAS, POS				

NOTE: Not all configurations may be compatible with one another. Please configure the product for specific 2D, Photometry, Downloads, Spec Sheet and Compatible mountings and power supplies.

MICRO STEP STAR - Wall Recessed - Low Voltage - LED High-Power - Round - Core Drill - Faceplate: Standard - Pattern B - Micro

Features



Lens factory adhered to fixture cap providing hermetically sealed optical compartment



Secured with flush, countersunk tamper resistant hardware



Machined solid billet faceplate provides unmatched strength and durability



Manufactured in the USA with sustainable processes



Water-tight anti-siphon plug prevents moisture ingress from wireways



Easily replaceable modular components reduce waste and extend fixture life

WARNING: This is a low voltage product. Please check "Mountings With A Power Supply" or "Power Supplies" to order remote transformer separately.

Technical

Driver: Low Voltage

Light Source (Type): LED High-Power

Material: Aluminum, Brass, Stainless Steel

CCT (K): Amber, 2700, 3500, 3000

CRI: 80, 90

Input Power (W): 3

Delivered Lumens (lm): 20 - 21

Shape: Round

Mount: Core Drill

Style: Faceplate: Standard - Pattern B - 90° Angle - Round

Version: Micro

Wiring Length: Standard, 25 Ft Leads

Finish: Standard Finishes, Premium Finishes, Other - RAL, Other - Custom Color, Brass Finishes, Stainless Steel Finishes

Body: Unibody design with enclosed, water-proof wireway, integral heat sink, fully machined from solid billet, anti-condensation and corrosion vent equalizes fixture pressure and eliminates potential for damage to internal components.

Material Detail: Furnished in stainless steel (304), Furnished in brass (360), Furnished in copper-free aluminum (6061-T6).

Aiming: 90° optical cutoff for mounting heights well below typical visual glare angles.

Light Source Detail: High power LEDs modular design with electrical disconnects.

Hardware: Tamper-resistant, stainless steel hardware. Hardware is black oxide treated for additional corrosion resistance.

Sealing: 'O' Ring provides water-tight seal., Anti-condensation and corrosion vent equalizes fixture pressure and eliminates potential for damage to internal components.

Finish Detail: Powder coat or metal finish options available for brass material., Metal finish option only for stainless steel material., StarGuard, our 15-stage chromate-free process, cleans and conversion coats aluminum components prior to application of Class 'A' TGIC polyester powder coating. It is RoHS compliant.

Warranty: 5-year limited warranty.

MICRO STEP STAR - Wall Recessed - Low Voltage - LED High-Power - Round - Core Drill - Faceplate: Standard - Pattern B - Micro

Finishes

STANDARD FINISHES



PREMIUM FINISHES



OTHER - RAL

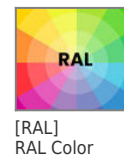

OTHER - CUSTOM COLOR

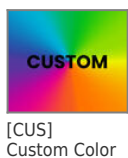

BRASS FINISHES

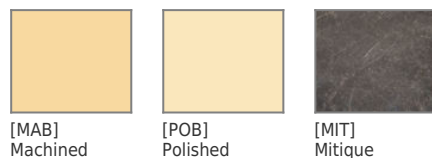

STAINLESS STEEL FINISHES

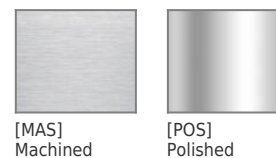

**MICRO STEP STAR - Wall Recessed - Low Voltage - LED
High-Power - Round - Core Drill - Faceplate: Standard -
Pattern B - Micro**

(Brass)

(Brass)

(Stainless
Steel)

(Stainless
Steel)

**MICRO STEP STAR - Wall Recessed - Low Voltage - LED
High-Power - Round - Core Drill - Faceplate: Standard -
Pattern B - Micro**

Light Source

Light Source	Optic	Beam Angle	CCT (K)	CRI	R9	Input Power (W)	Delivered Lumens (Lm)	CBCP
e70	-	30	2700	80	>15	3	20	
e71	-	30	3000	80	>15	3	21	
e73	-	30	Amber			3		
e85	-	30	2700	90	>50	3		
e86	-	30	3000	90	>50	3		
e87	-	30	3500	80	>15	3		